

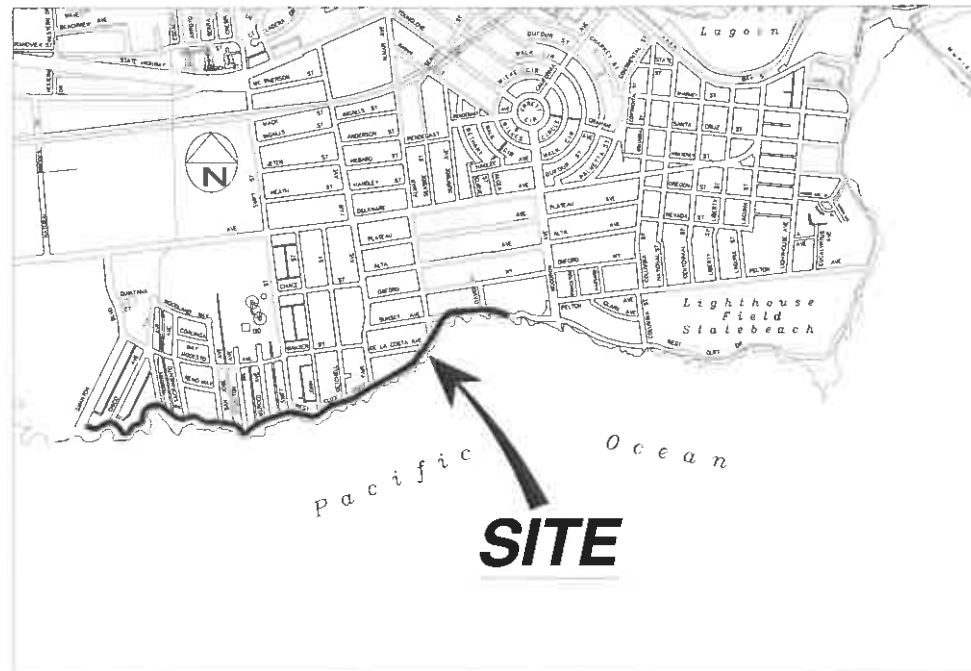

PUBLIC WORKS DEPARTMENT

WEST CLIFF MULTI-USE PATH REHABILITATION PROJECT - PHASE 3 CITY PROJECT NO. M 400819



VICINITY MAP

N.T.S.

SHEET INDEX

1. TITLE SHEET
2. IMPROVEMENT PLANS
LIMIT OF WORK 6+60 to 14+25, SWANTON AND CHICO
3. IMPROVEMENT PLANS
14+25 to 21+50, AUBURN
4. IMPROVEMENT PLANS
21+50 to 32+00, SACRAMENTO, SAN JOSE, AND STOCKTON
5. IMPROVEMENT PLANS
32+00 to 43+00, MERCED, SWIFT, JOHN, AND GETCHELL
6. IMPROVEMENT PLANS
43+00 to 55+00, GETCHELL, FAIR, AND DE LACOSTA
7. IMPROVEMENT PLANS,
LIMIT OF WORK 55+00 to 64+65, ALMAR, SUNSET,
AND DAVID
8. DETAILS AND TYPICAL SECTIONS

APPROVED BY:

R.C.E. NO. 74847

ASSISTANT DIRECTOR / CITY ENGINEER
CITY OF SANTA CRUZ



REFERENCES	DATE	AUGUST 1, 2023	SCALE	N.A.
FIELD BOOK: 8	DRAWN	S. METZ	SHEET	1 OF 8
DRAWING #: #	DESIGN	M. LIZARRAGA	VAULT NO.	
	CHECKED	K. CROSSLEY		# 7034

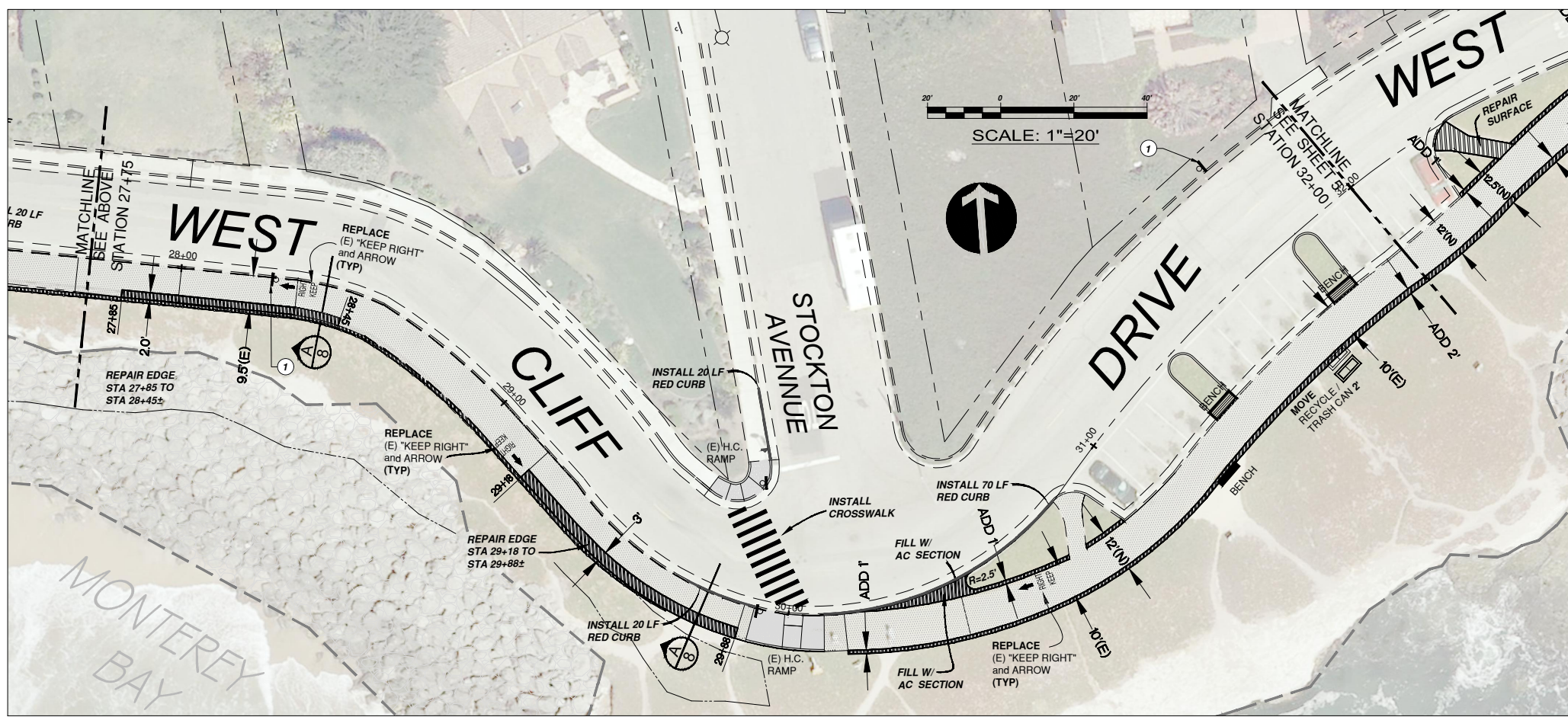
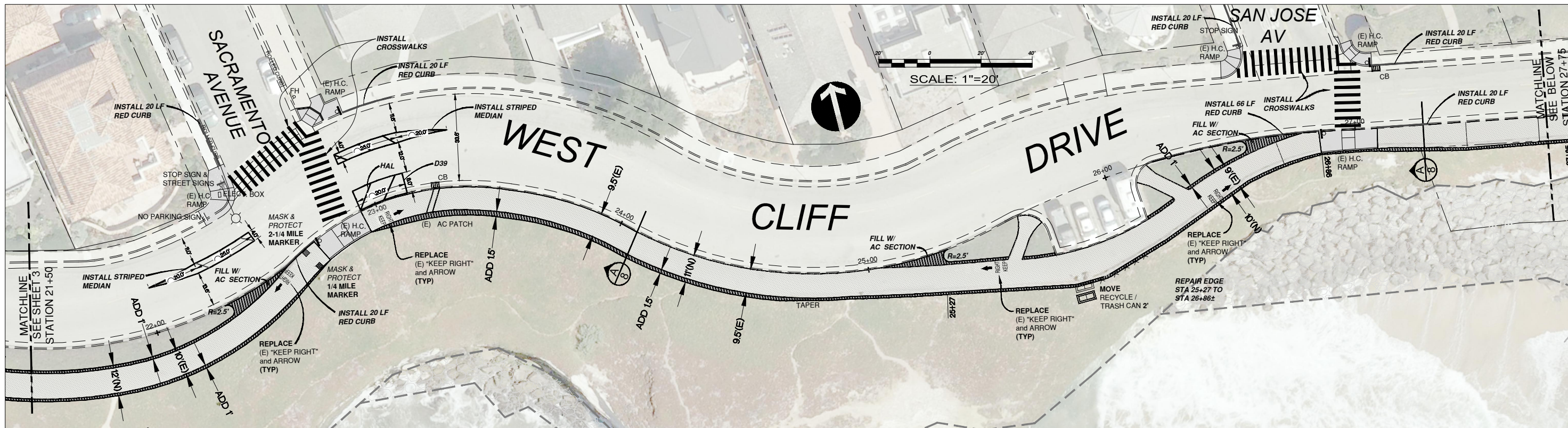

ASPHALT FLATWORK LEGEND

NEW SURFACE AT EXISTING PATH (SEE DETAIL A ON SHEET 8)	
FULL SECTION ADDITION TO PATH WIDTH (SEE DETAIL B ON SHEET 8)	
NEW FULL SECTION PATH AREA (SEE DETAIL C ON SHEET 8)	

STRIPING NOTES:

STRIPED MEDIAN: STRIPED MEDIAN (INSIDE/OUTSIDE DETAIL 39 AND 6" WHITE HATCH, 45° ANGLE, 10" GAP)

RED CURB: RED CURB PAINT

CROSSWALK: 12" WHITE LINE

D39: DETAIL 39 (BIKE LANE LINE)

HAL: 4" HATCH LINE, 45° ANGLE, 8" GAP



REVISIONS

NO.	DESCRIPTION

CITY OF
SANTA CRUZ
PUBLIC WORKS DEPARTMENT
809 Center Street, Room 201
Santa Cruz, CA 95060

**WEST CLIFF MULTI-USE PATH
REHABILITATION PROJECT**
PHASE 3 - CITY PROJECT NO. M400819

REFERENCES	DATE	AUGUST 1, 2023	SCALE	1"-20'
FIELD BOOK:	DRAWN	S. METZ	SHEET	4 OF 8
DRAWING #:	DESIGN	M. LIZARRAGA	VAULT NO.	# 7034
	CHECKED	K. CROSSLEY		

Project: M400819 - West Cliff Multi-Use Path Rehabilitation Project - Phase 3 - City Project No. M400819
 Drawing: WEST CLIFF DRIVE PHASE 3 PLAN
 Date: 08/01/2023
 Scale: 1"=20'
 Author: S. Metz
 Designer: M. Lizarraga
 Checker: K. Crossley
 Engineer: K. Crossley
 License: C 74847
 State: CA
 Exp: 12/31/2024

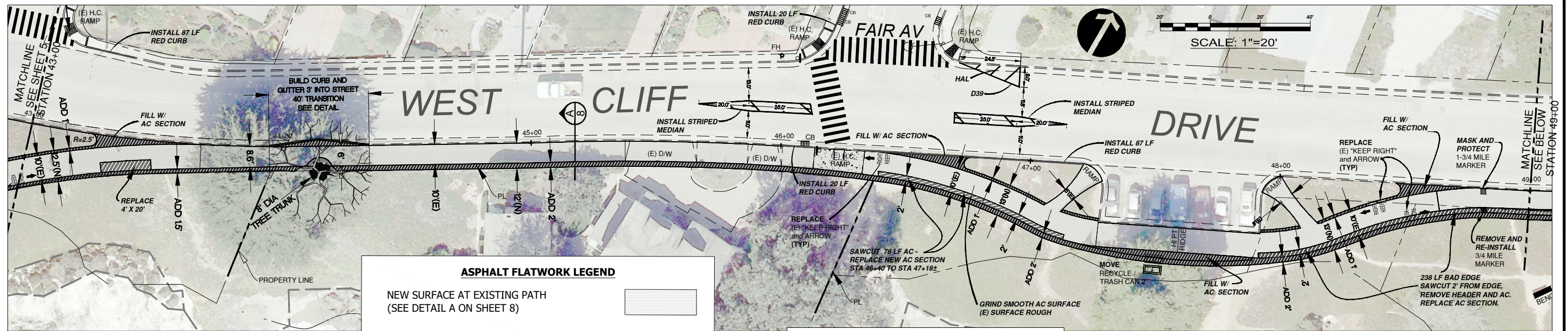

ASPHALT FLATWORK LEGEND

- NEW SURFACE AT EXISTING PATH (SEE DETAIL A ON SHEET 8)
- FULL SECTION ADDITION TO PATH WIDTH (SEE DETAIL B ON SHEET 8)
- NEW FULL SECTION PATH AREA (SEE DETAIL C ON SHEET 8)

STRIPING NOTES:

- STRIPED MEDIAN:** STRIPED MEDIAN (INSIDE/OUTSIDE DETAIL 39 AND 6" WHITE HATCH, 45° ANGLE, 10' GAP)
- RED CURB:** RED CURB PAINT
- CROSSWALK:** 12" WHITE LINE
- D39:** DETAIL 39 (BIKE LANE LINE)
- HAL:** 4" HATCH LINE, 45° ANGLE, 8' GAP

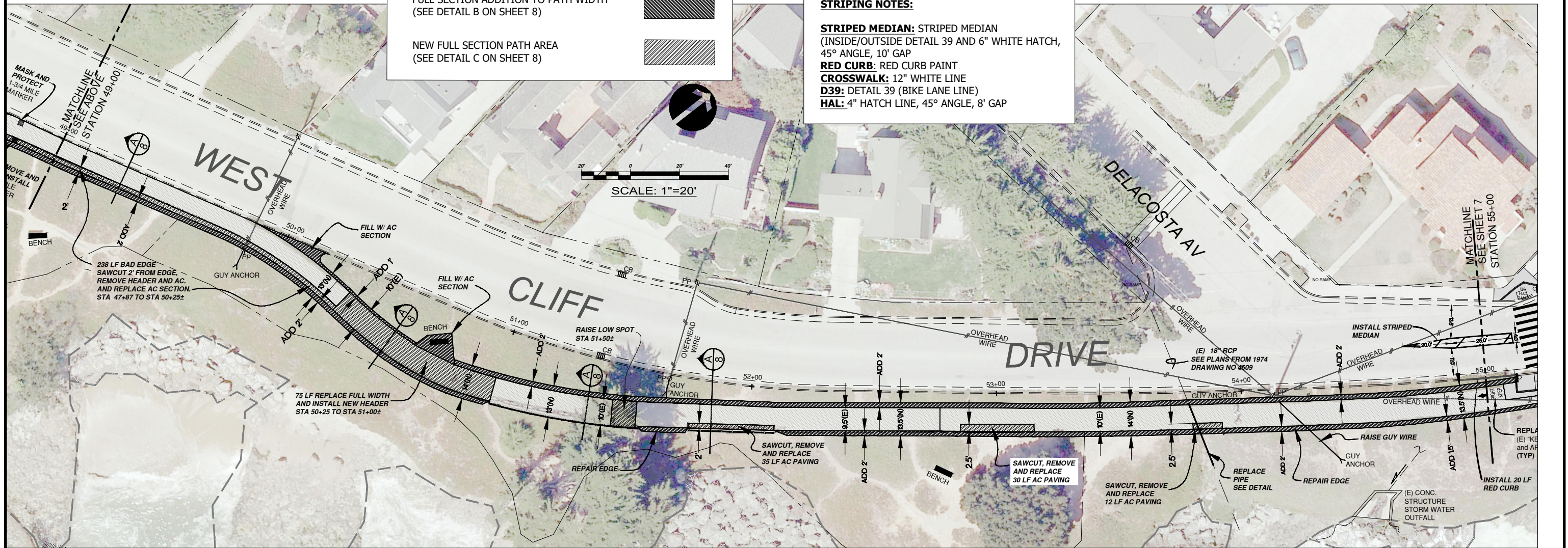

REVISIONS

NO.	DATE	DESCRIPTION

CITY OF
SANTA CRUZ
PUBLIC WORKS DEPARTMENT
809 Center Street, Room 201
Santa Cruz, CA 95060

**WEST CLIFF MULTI-USE PATH
REHABILITATION PROJECT**
PHASE 3 - CITY PROJECT NO. M400819

REFERENCES	DATE	SCALE
FIELD BOOK:	AUGUST 1, 2023	AS NOTED
DRAWING #:	S. METZ	SHEET 6 OF 8
	M. LIZARRAGA	VAULT NO.
	K. CROSSLEY	# 7034

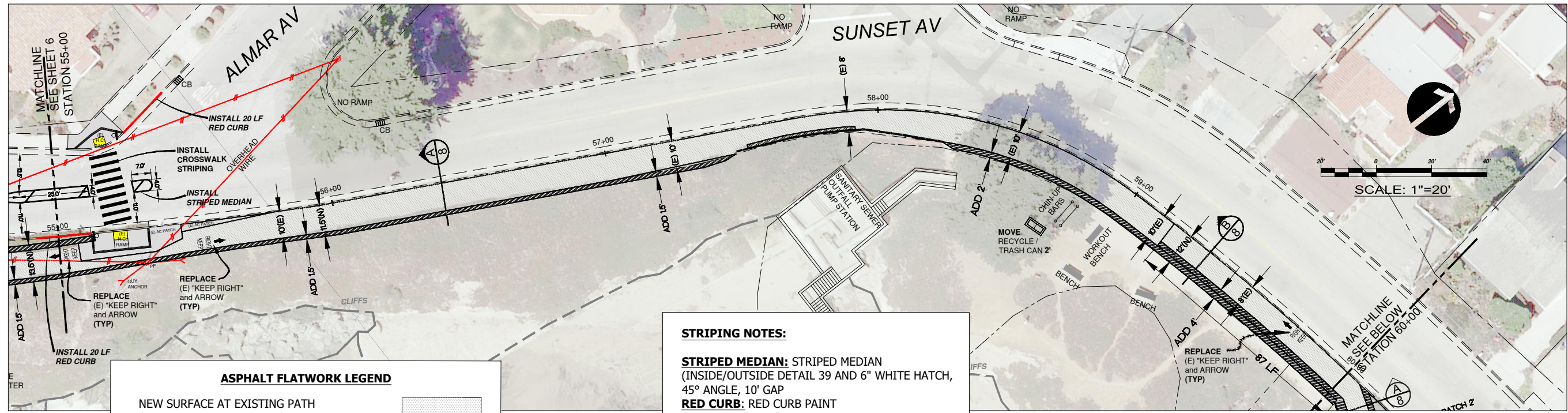

ASPHALT FLATWORK LEGEND

- NEW SURFACE AT EXISTING PATH (SEE DETAIL A ON SHEET 8)
- FULL SECTION ADDITION TO PATH WIDTH (SEE DETAIL B ON SHEET 8)
- NEW FULL SECTION PATH AREA (SEE DETAIL C ON SHEET 8)

STRIPING NOTES:

STRIPED MEDIAN: STRIPED MEDIAN (INSIDE/OUTSIDE DETAIL 39 AND 6" WHITE HATCH, 45° ANGLE, 10' GAP)

RED CURB: RED CURB PAINT

CROSSWALK: 12" WHITE LINE

D39: DETAIL 39 (BIKE LANE LINE)

HAL: 4" HATCH LINE, 45° ANGLE, 8' GAP

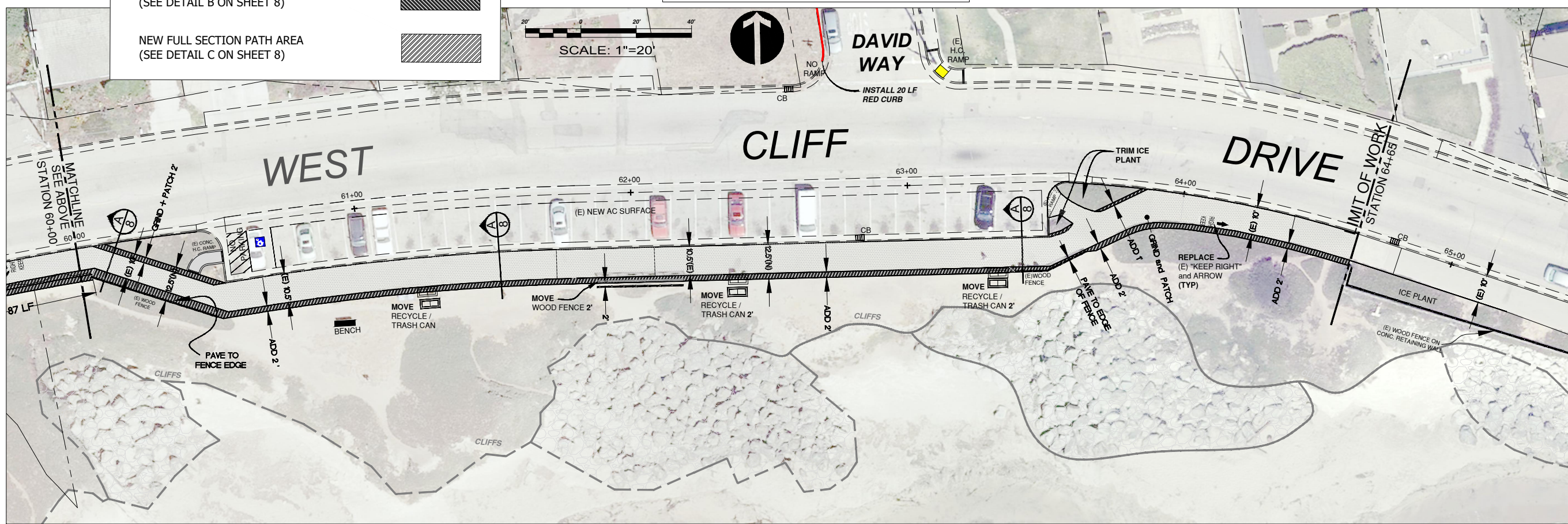

REVISIONS

CITY OF
SANTA CRUZ
PUBLIC WORKS DEPARTMENT
809 Center Street, Room 201
Santa Cruz, CA 95060

**WEST CLIFF MULTI-USE PATH
REHABILITATION PROJECT**
PHASE 3 - CITY PROJECT NO. M400819

REFERENCES FIELD BOOK: DRAWING #:	DATE	AUGUST 1, 2023	SCALE	AS NOTED
	DRAWN	S. METZ	SHEET	7 OF 8
	DESIGN	M. LIZARRAGA	VAULT NO.	
	CHECKED	K. CROSSLEY	#	7034

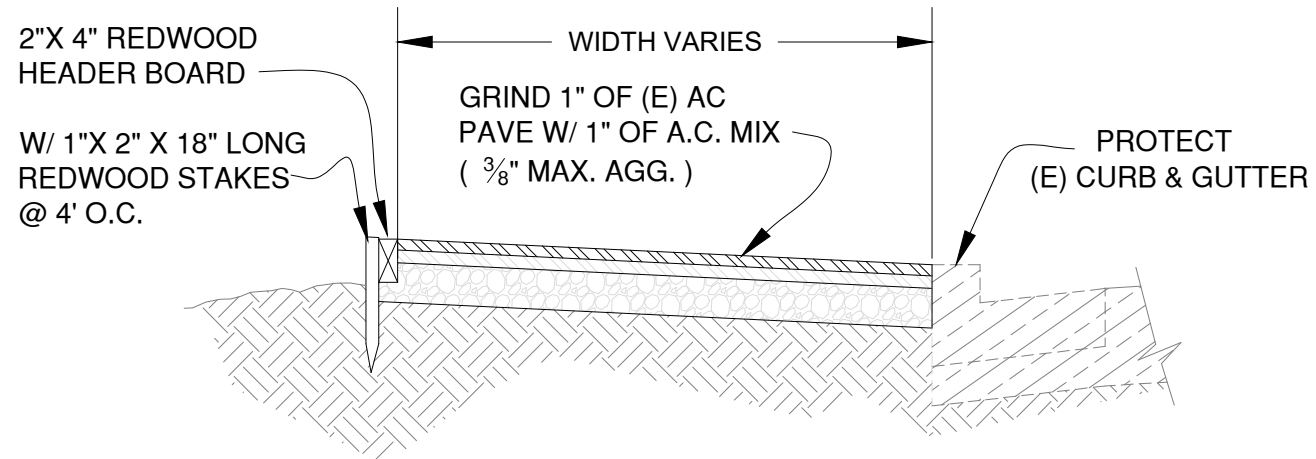

NEW SURFACE (EXISTING PATH) A
8
N.T.S.

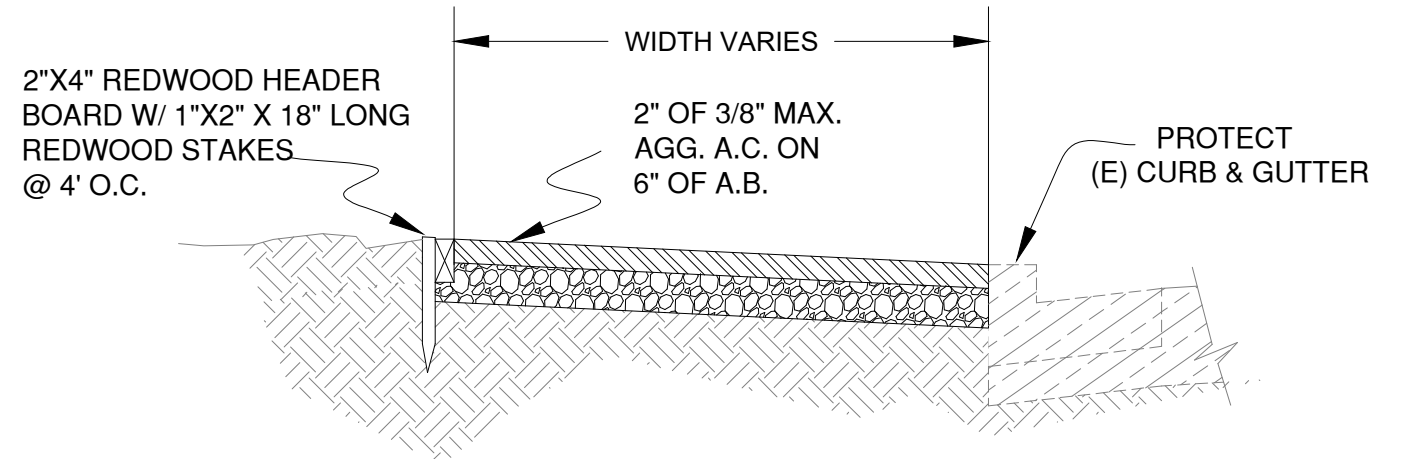

NEW FULL SECTION C
8
PATH AREA
N.T.S.

ADDITIONAL WIDTH TO EXISTING PATH
REMOVE AND REPLACE W/ 2" AC ON 6" AB. (3/8" MAX AGG)

2"X 4" REDWOOD HEADER BOARD
W/ 1"X 2" X 18" LONG REDWOOD STAKES @ 4' O.C.

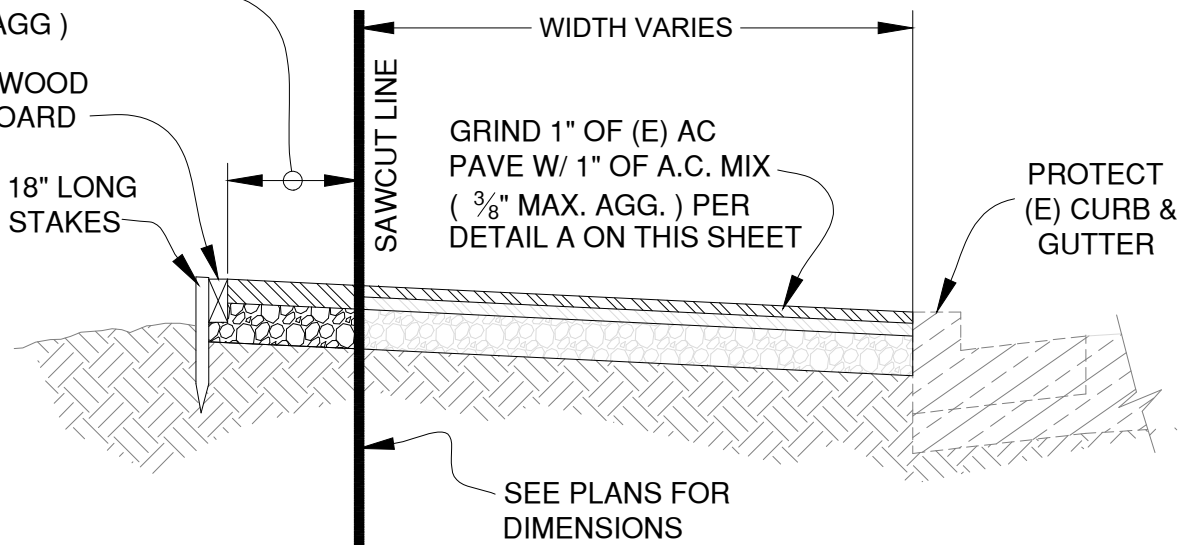

FULL SECTION ADDITION TO PATH WIDTH B
8
N.T.S.

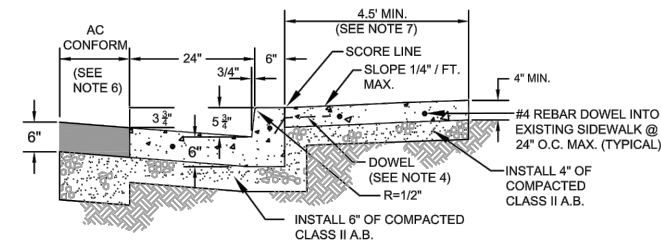

STANDARD CURB, GUTTER & SIDEWALK

NOTES:

- ALL CONCRETE TO BE SIX SACK, CLASS "A" PLANT MIXED PCC.
- COMPACT SUBBASE SOIL TO 95% RELATIVE COMPACTION AT OPTIMUM MOISTURE CONTENT TO A DEPTH OF 6".
- STANDARD CURB, GUTTER AND SIDEWALK SHALL BE A MONOLITHIC POUR UNLESS CURB AND GUTTER ARE EXISTING.
- IF ANY CURB, GUTTER OR SIDEWALK ARE EXISTING, DOWEL INTO EXISTING CONCRETE EVERY 24". USE 18" LONG #4 DOWELS, INSERT 4" INTO CURB. BEND DOWEL AT BACK OF CURB AS SHOWN.
- SCORE SIDEWALK EVERY 4 FT. PLACE EXPANSION JOINTS EVERY 60 FEET WITH DEEP JOINTS EVERY 12 FT.
- WIDTH OF A.C. CONFORM SHALL BE A MINIMUM OF 2 FEET. A.C. CONFORM SHALL BE A MINIMUM OF 6" THICK ON TOP OF 6" OF CLASS II A.B.
- CITY ENGINEER MAY REQUIRE MODIFICATIONS OF MINIMUM WIDTH TO CONFORM TO SURROUNDING NEIGHBORHOOD.

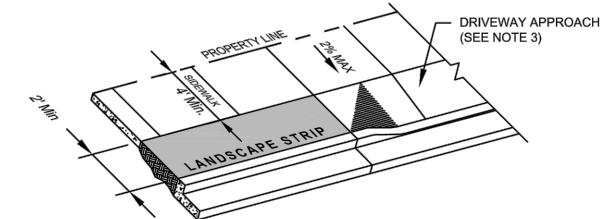

SIDEWALK LANDSCAPE STRIP INSTALLATION

NOTES:

- PROPERTIES THAT HAVE A 6 FT. OR GREATER PROPERTY LINE SETBACK FROM THE STREET WILL BE REQUIRED TO INSTALL A LANDSCAPE STRIP BETWEEN THE BACK OF CURB AND SIDEWALK.
- SLOPE SIDEWALK AND LANDSCAPING STRIP TOWARD CURB AT 1/4" / FT. (2%) MAX.
- FOR DRIVEWAY APPROACH CONSTRUCTION SEE CITY DETAIL 9 OF 23 TYPE "A" DRIVEWAY WITH PLANTER.

CITY OF SANTA CRUZ PUBLIC WORKS DEPARTMENT ENGINEERING DIVISION	CURB, GUTTER AND SIDEWALK CITY ENGINEER: _____	DATE: MARCH 2011
		SCALE: NONE
		DWG NO. 8 OF 20



REVISIONS

NO.	DESCRIPTION

CITY OF
SANTA CRUZ
PUBLIC WORKS DEPARTMENT
809 Center Street, Room 201
Santa Cruz, CA 95060

**WEST CLIFF MULTI-USE PATH
REHABILITATION PROJECT**
PHASE 3 - CITY PROJECT NO. M400819

REFERENCES FIELD BOOK: DRAWING #:	DATE	AUGUST 1, 2023	SCALE	N.T.S.
	DRAWN	S. METZ	SHEET	8 OF 8
	DESIGN	T. LAU	VAULT NO.	
	CHECKED	C. SCHNEITER	#	7034