

SOURCE: USGS 7.5-Minute Series Santa Cruz Quadrangle



FIGURE 1-1

Project Location

Santa Cruz Wharf Maintenance Project



SOURCE: Santa Cruz Wharf Master Plan (2014)

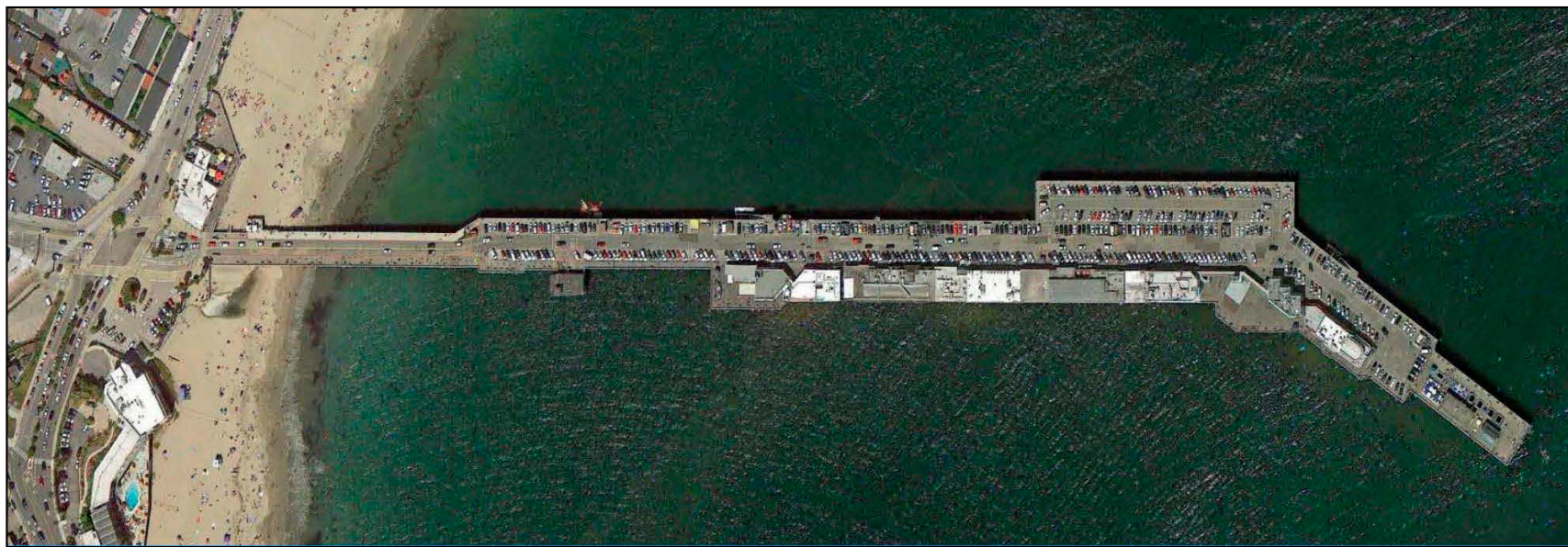
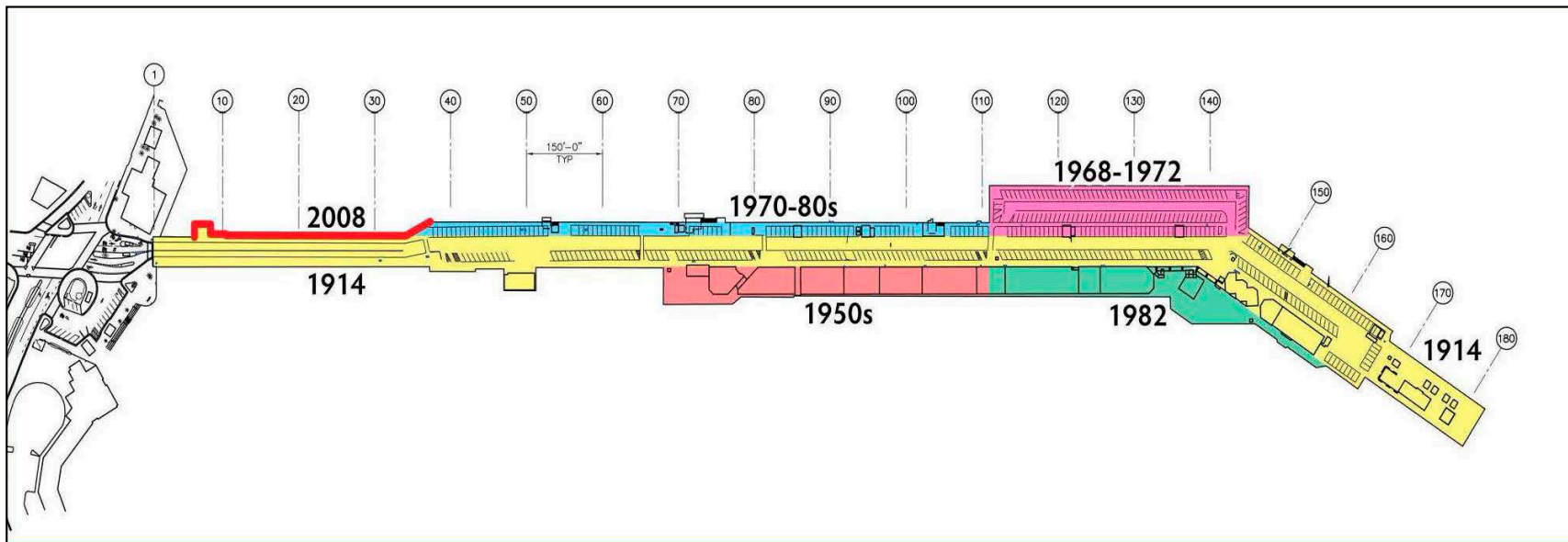

SOURCE: Santa Cruz Wharf Master Plan (2014)

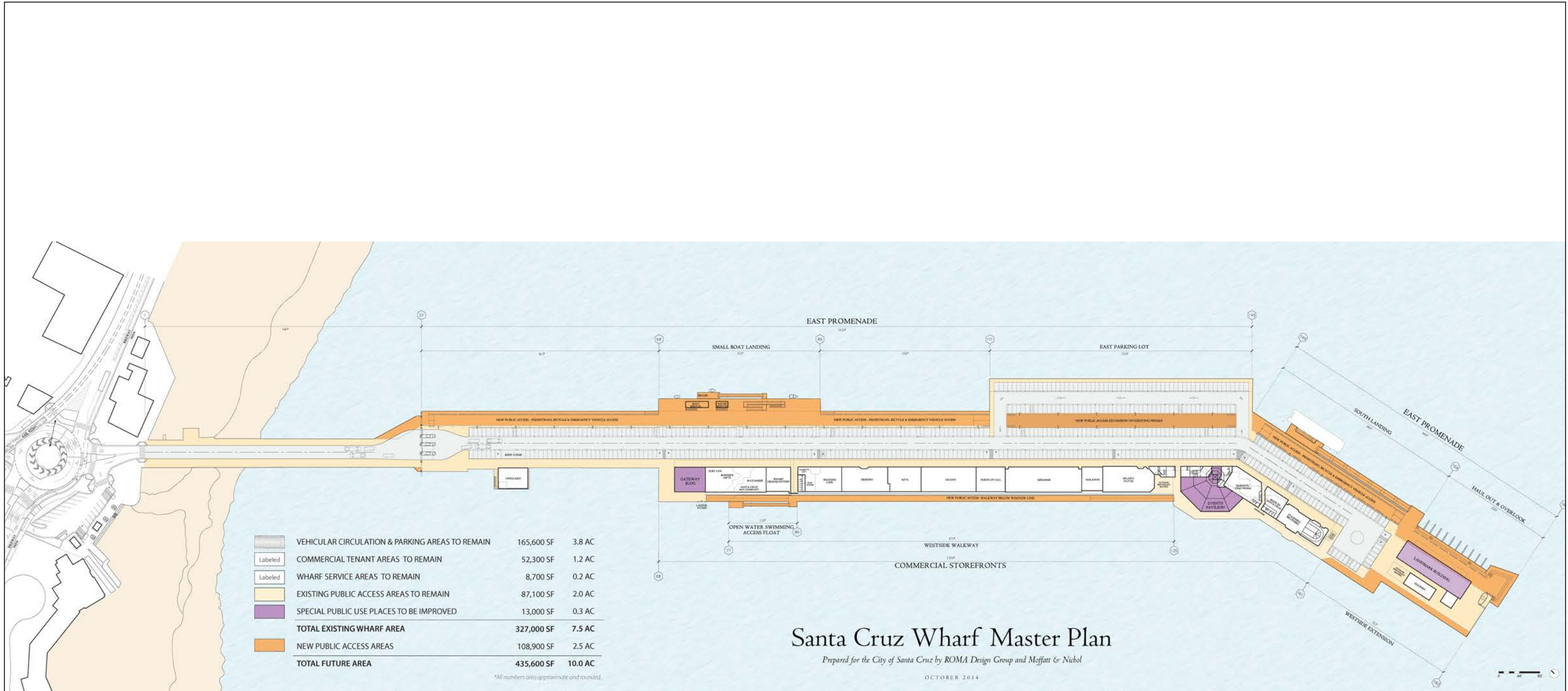

Santa Cruz Wharf Master Plan

Prepared for the City of Santa Cruz by ROMA Design Group and Moffat & Nichol

OCTOBER 2014

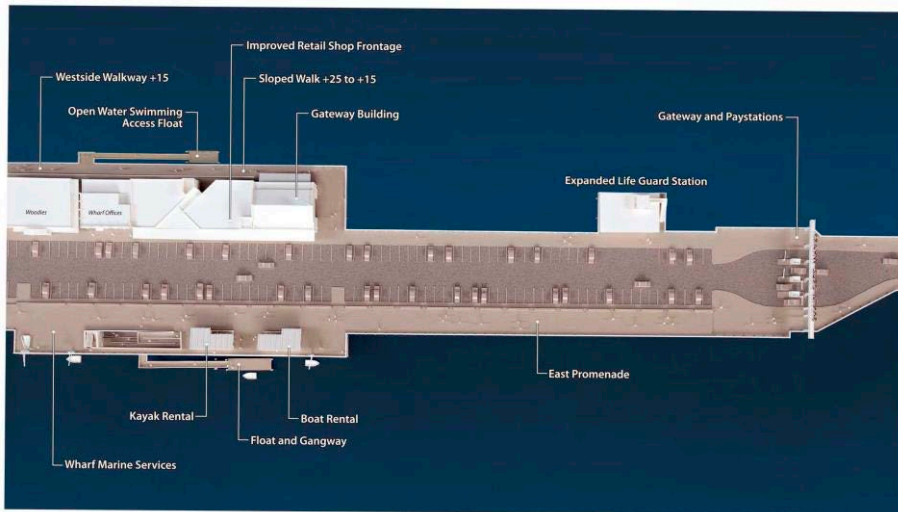
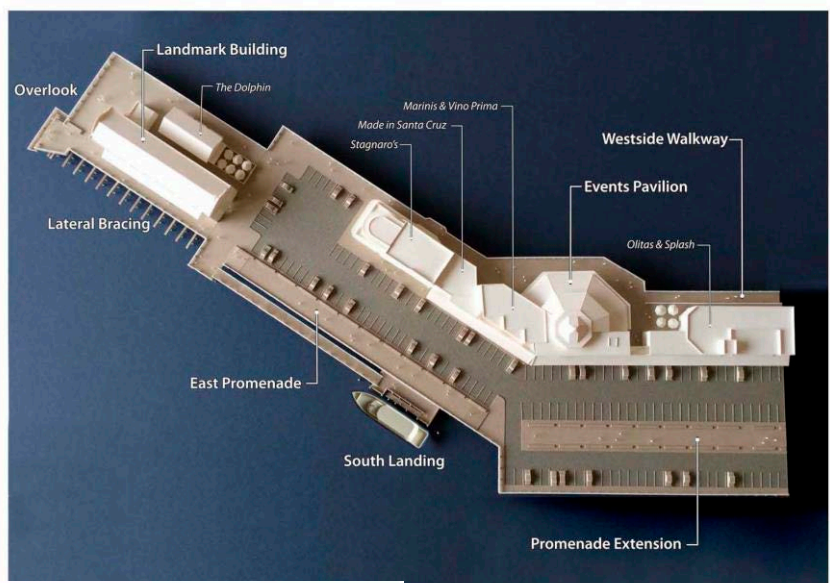
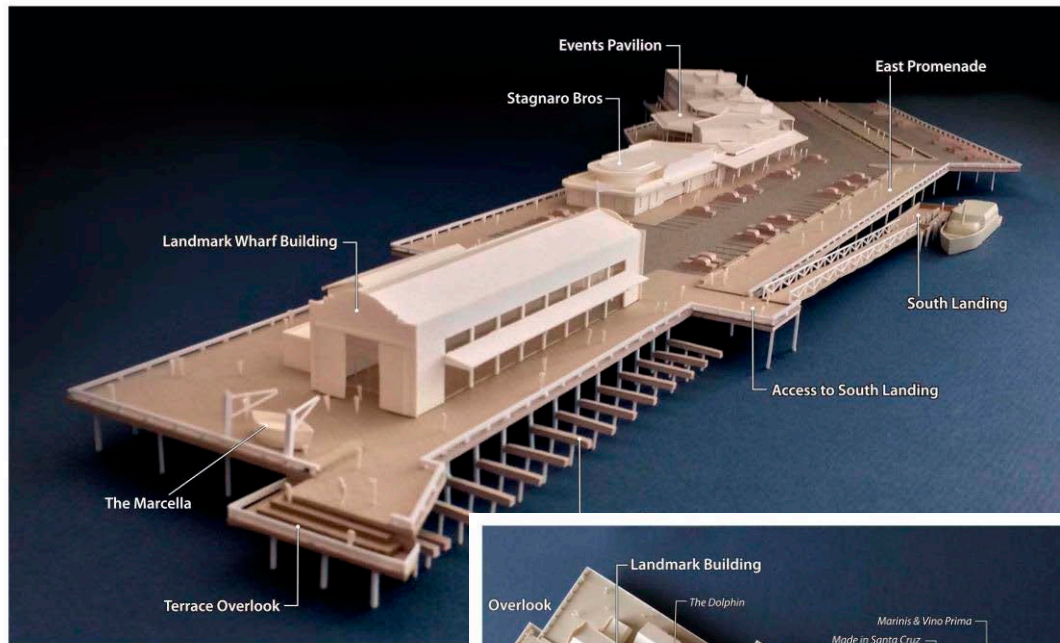

SOURCE: Santa Cruz Wharf Master Plan (2014)

FIGURE 3-3

Model of Proposed Wharf Development
Santa Cruz Wharf Master Plan EIR

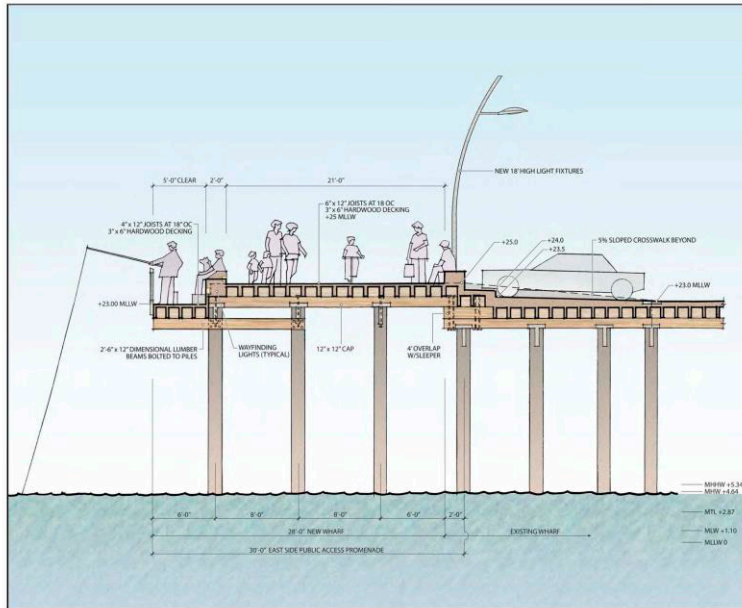

East Promenade

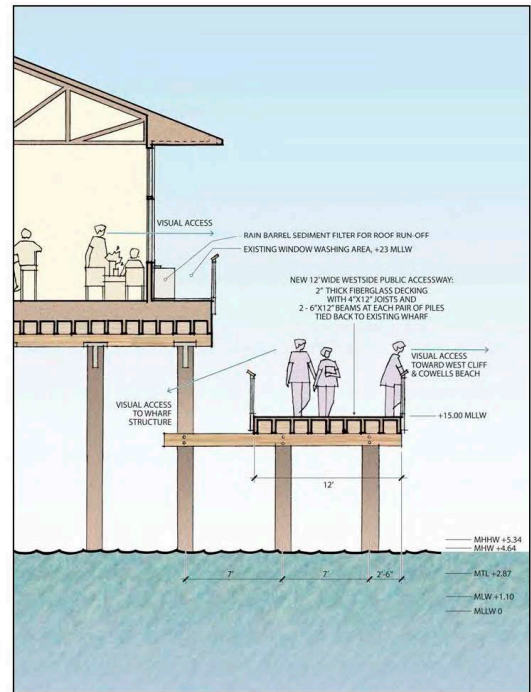

Westside Walkway

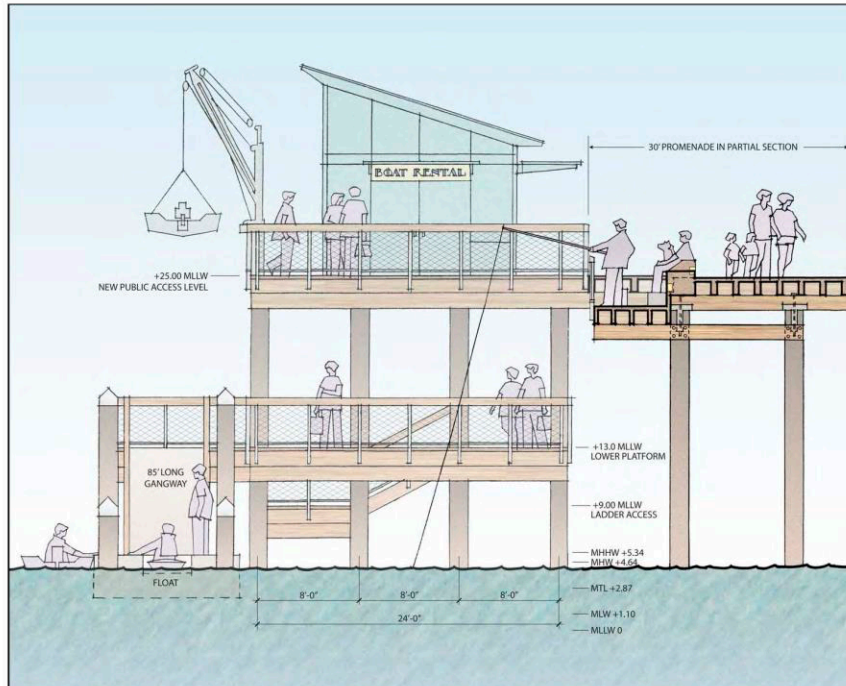

North Elevation of Small Boat Landing Adjacent to East Promenade

SOURCE: Santa Cruz Wharf Master Plan (2014)

FIGURE 3-4

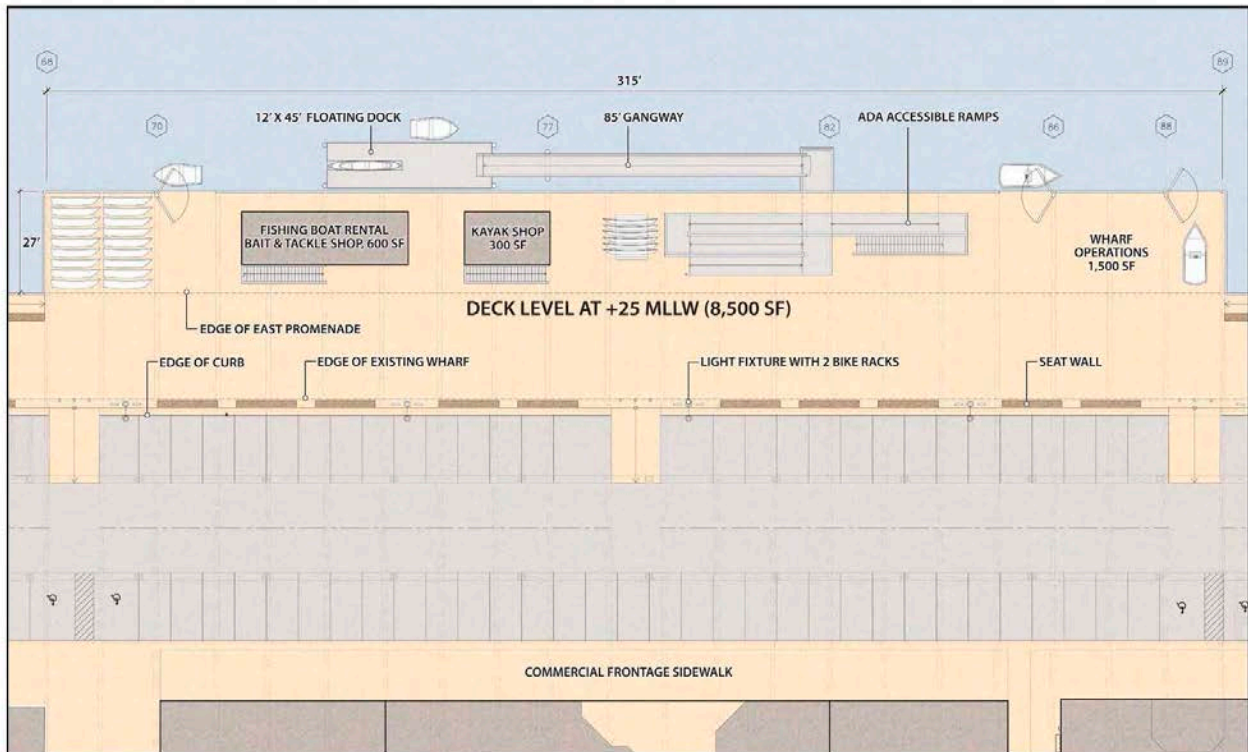
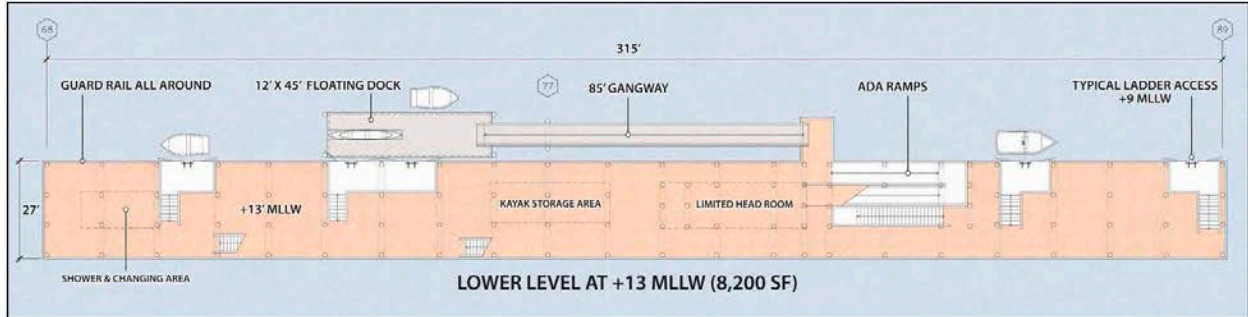

Plan of the deck and platform levels of the Small Boat Landing

SOURCE: Santa Cruz Wharf Master Plan (2014)

FIGURE 3-5A

Concept Site Plan - Small Boat Landing

Santa Cruz Wharf Master Plan EIR

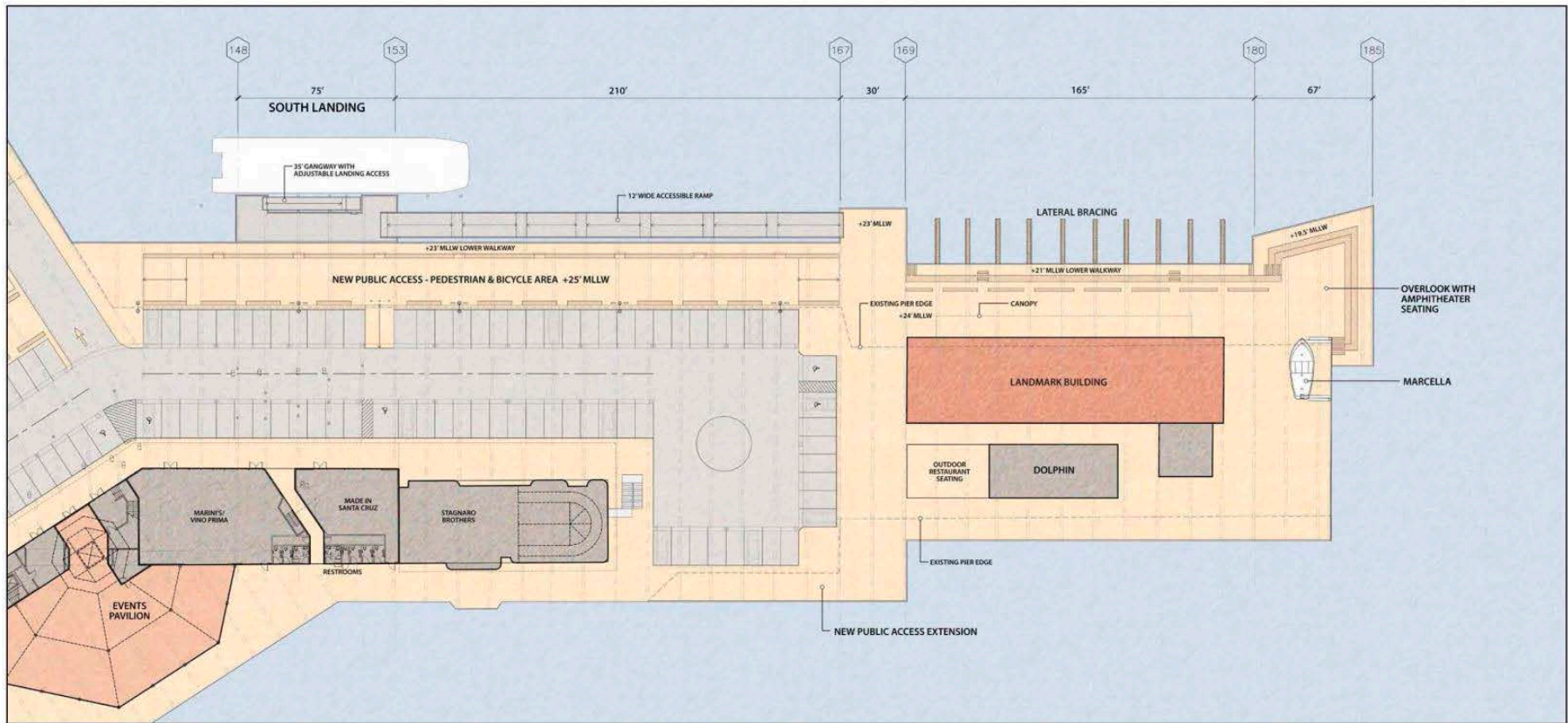

SOURCE: Santa Cruz Wharf Master Plan (2014)

FIGURE 3-5B
Concept Site Plan - South Landing
 Santa Cruz Wharf Master Plan EIR

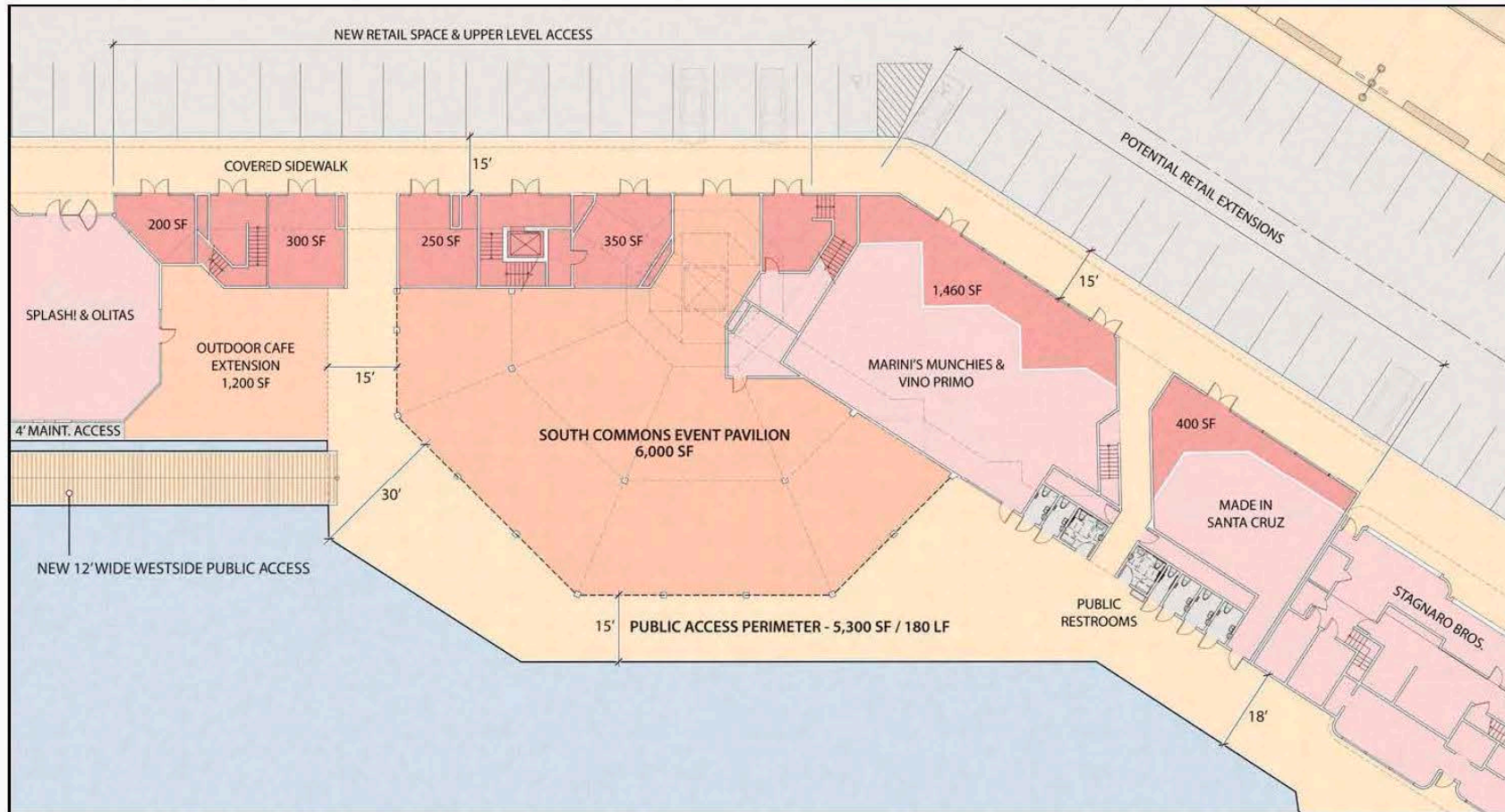

The plan for the Events Pavilion includes the addition of small commercial tenant spaces and the extension of the existing commercial buildings.

SOURCE: Santa Cruz Wharf Master Plan (2014)

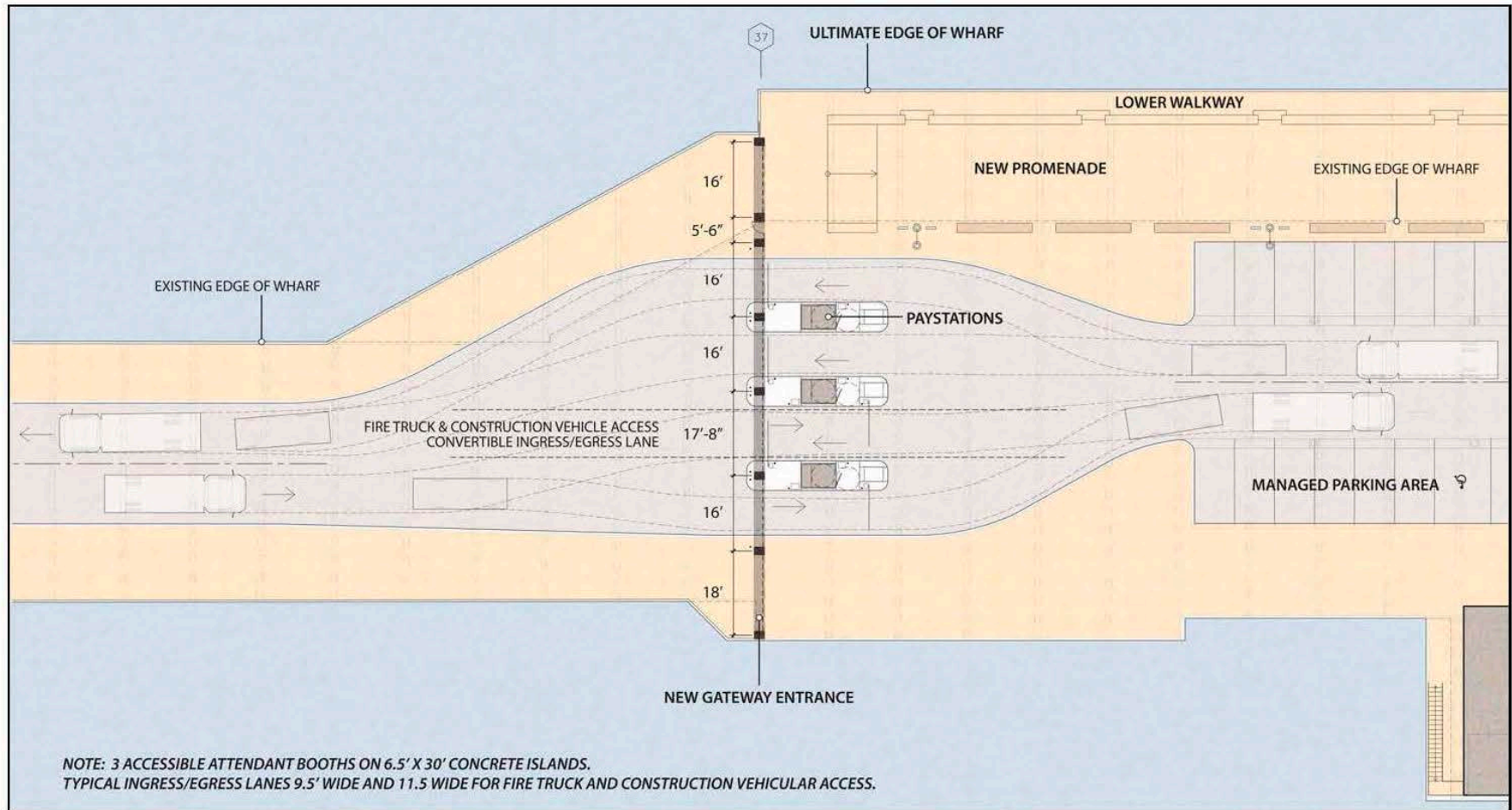

The pay stations provide four lanes in and out of the Wharf – two in/out on most days and one in and three out when needed.

SOURCE: Santa Cruz Wharf Master Plan (2014)

Existing Wharf Entrance

Relocated Entrance

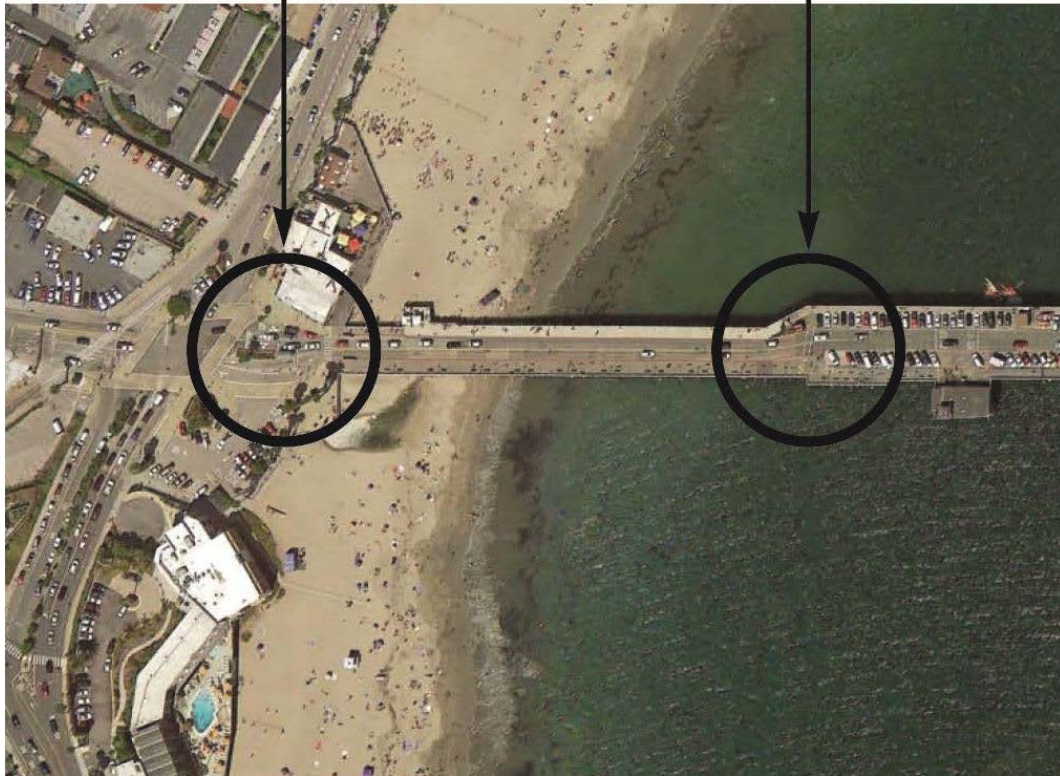

The Master Plan provides a general example of signage, but a specific design, size, shape, and color will be developed and provided for public review before a final design is selected

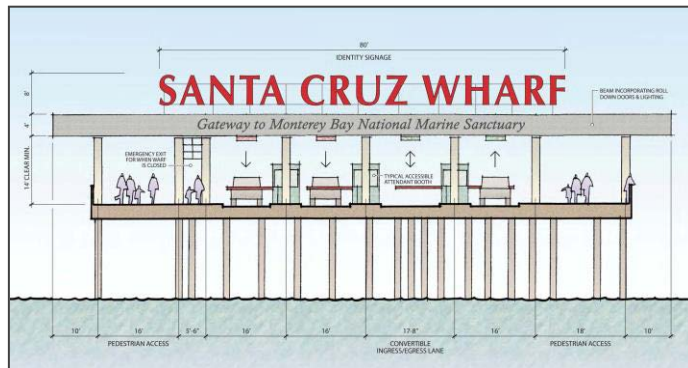

SOURCE: City of Santa Cruz (2017)

FIGURE 3-6

Proposed Wharf Entrance Relocation

Santa Cruz Wharf Master Plan EIR

EAST PROMENADE SANTA CRUZ WHARF

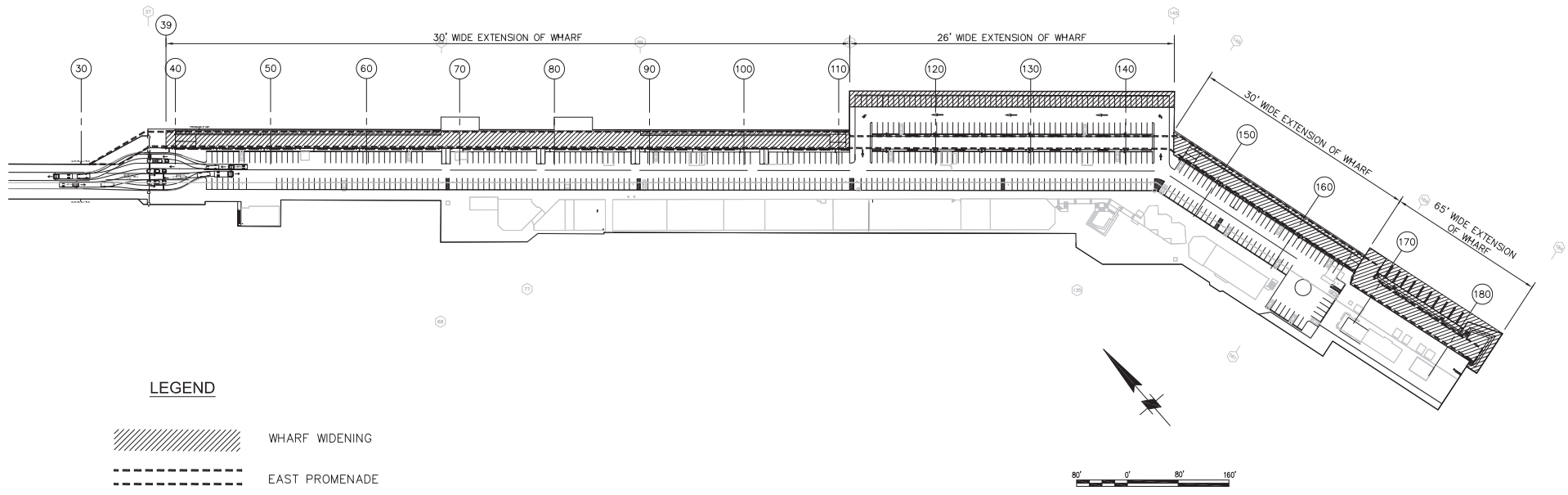

SOURCE: City of Santa Cruz Public Works Department

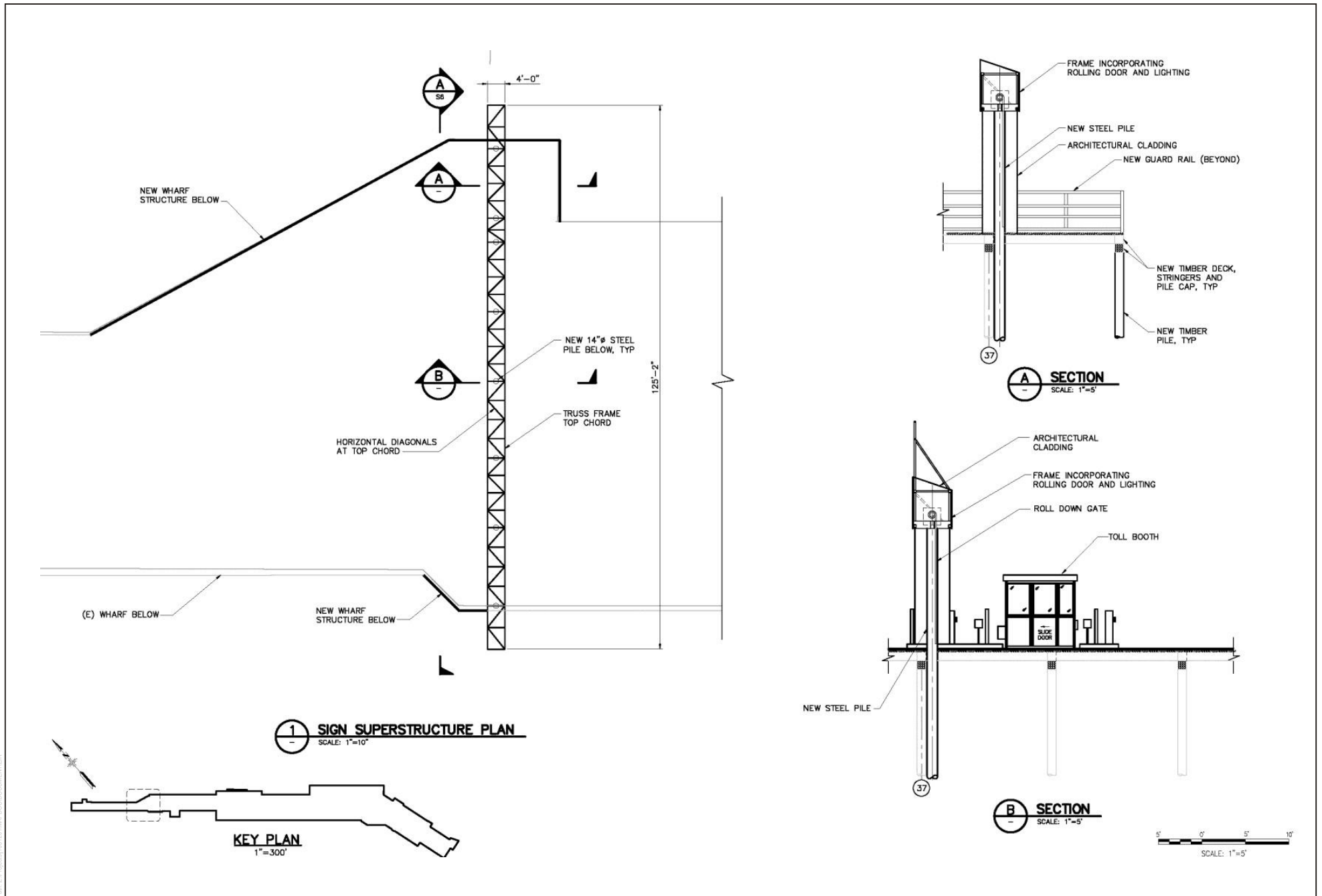

SOURCE: City of Santa Cruz Public Works Department

FIGURE 3-7B

Entry Gate/Sign Structure Cross Section

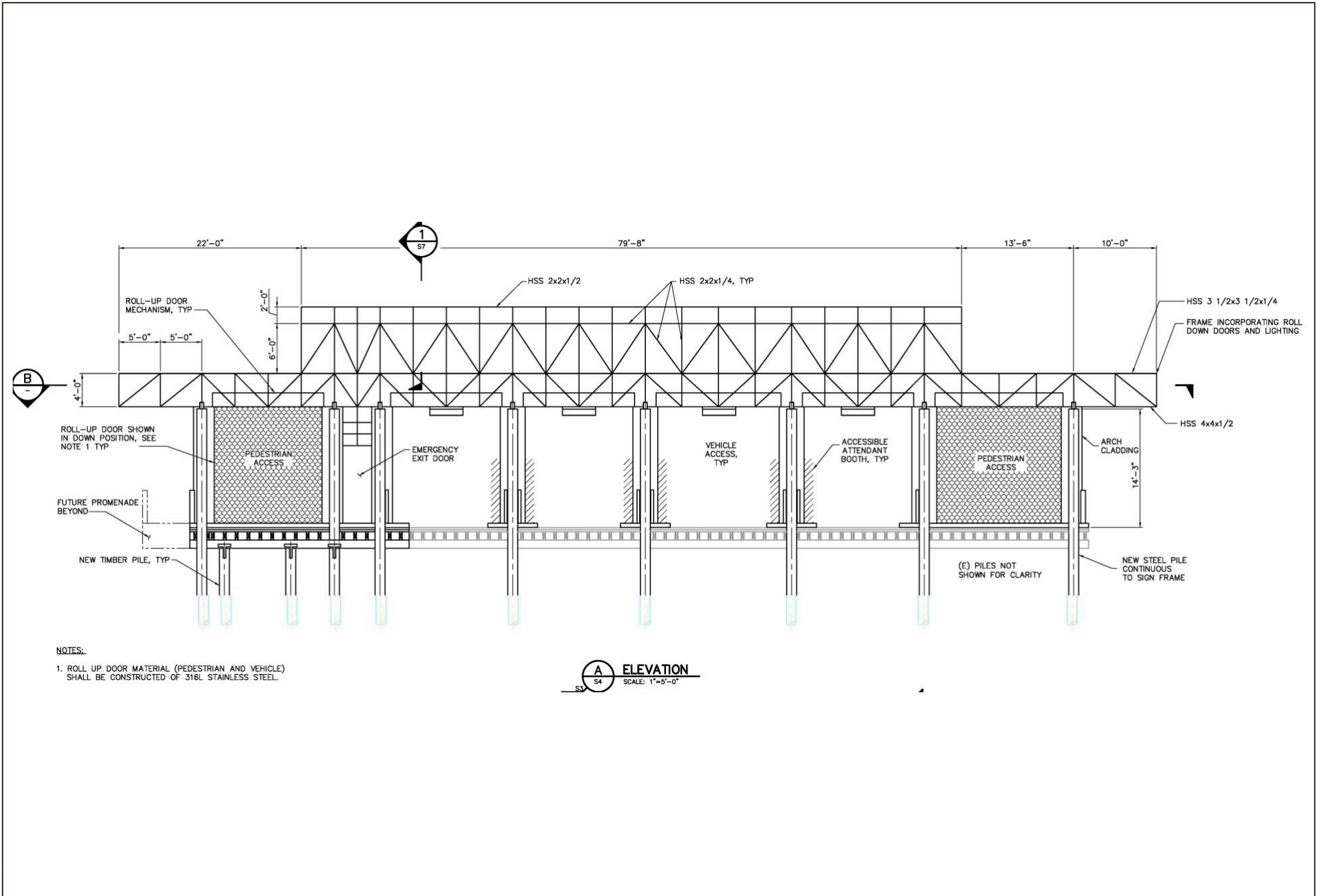

SOURCE: City of Santa Cruz Public Works Department

EAST PROMENADE SANTA CRUZ WHARF

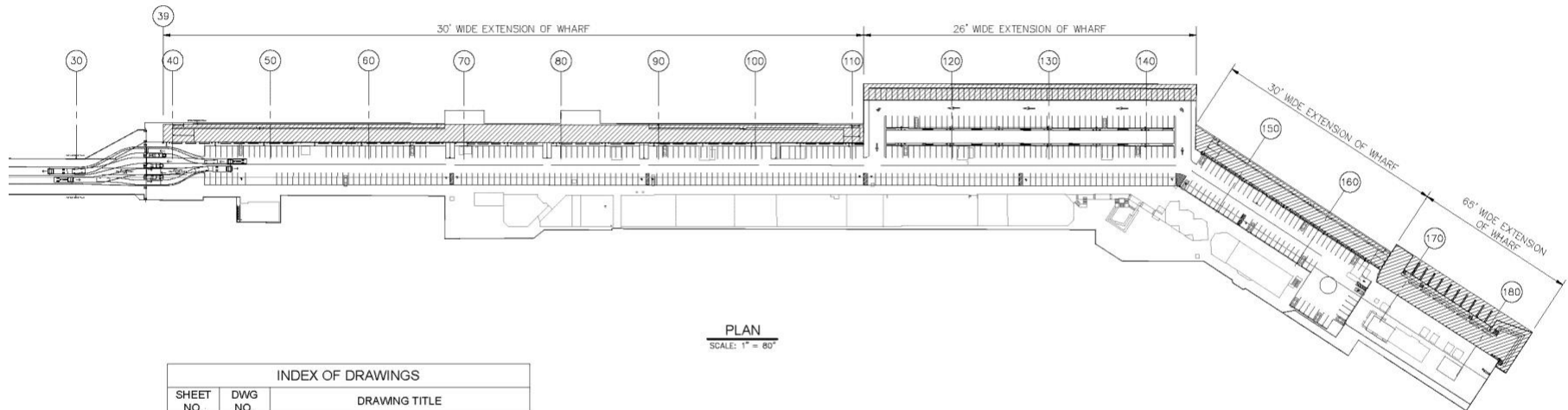

PLAN
SCALE: 1" = 80'

INDEX OF DRAWINGS		
SHEET NO.	DWG NO.	DRAWING TITLE
1	T1	TITLE SHEET
2	S1	GENERAL NOTES
3	S2	PLAN AND SECTIONS - 1
4	S3	PLAN AND SECTIONS - 2
5	S4	PLAN AND SECTIONS - 3
6	S5	PLAN AND SECTIONS - 4
7	S6	STRIPING PLAN - 1
8	S7	STRIPING PLAN - 2
9	S8	STRIPING PLAN - 3
10	S10	PLAN AND SECTIONS - KAYAK DOCK
11	S11	DETAIL - PLAN AND ELEVATION
12	S12	PLAN AND SECTIONS - RENTAL, PUBLIC, STAFF
13	S13	RAMP SECTIONS
14	S14	DETAILS

NOTES:

1. PARKING ARRANGEMENT SHOWN IS REVISED FROM EXISTING. SEE SHEETS S6, S7 AND S8.

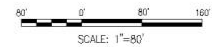

SOURCE: City of Santa Cruz Public Works Department

