

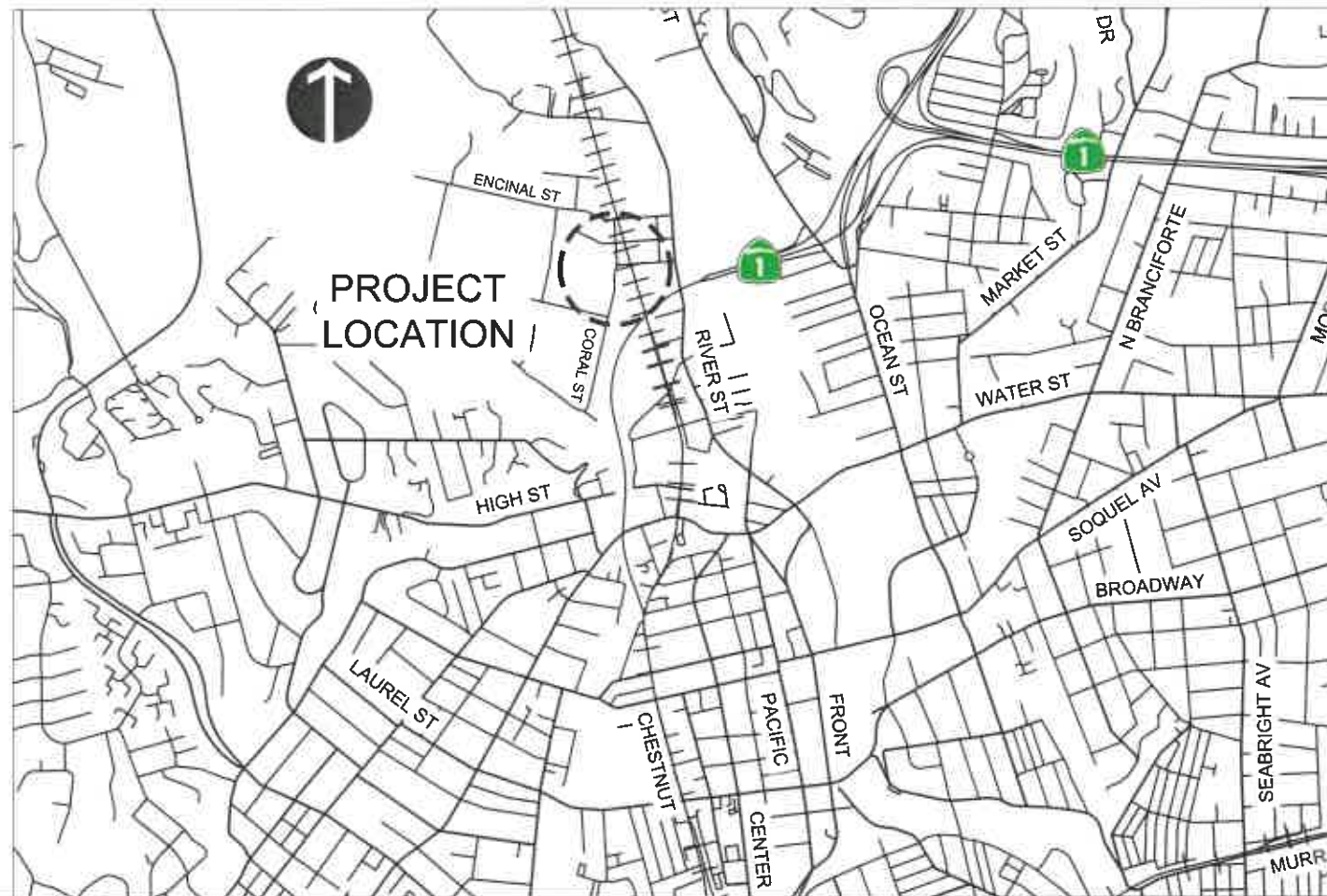

PUBLIC WORKS DEPARTMENT CORAL STREET - LIMEKILN STREET IMPROVEMENTS PROJECT



SHEET	NAME
1	TITLE SHEET
2	IMPROVEMENT PLAN
3	DETAIL SHEET



REVISIONS



CITY OF
SANTA CRUZ
PUBLIC WORKS DEPARTMENT
809 Center Street, Room 201
Santa Cruz, CA 95060



**CORAL ST - LIMEKILN ST
TITLE SHEET**

REFERENCES	DATE	SCALE
FIELD BOOK: #	04/16/2024	NOT TO SCALE
DRAWING #:	DnC	SHEET 1 OF 3
#	DnC	VAULT NO.
	CHECKED MS/DE/RV	#7160

CONSTRUCTION NOTES:

1. **D22:** DETAIL 22 STRIPE
2. **D29:** DETAIL 29 STRIPE
3. **CW:** CONTINENTAL CROSSWALK (12" WHITE STRIPE, 24" GAP)
4. **DWS:** INSTALL DETECTABLE WARNING SURFACE (CAST IN PLACE)
5. **DYLT:** DAYLIGHTING STRIPE (SEE DETAIL THIS SHEET)
6. **ISL:** MEDIAN ISLAND (SEE DETAIL THIS SHEET)
7. **LL:** 12" LIMIT LINE
8. **PST:** INSTALL STANDARD SIGN POST
9. **R1-1:** "STOP" SIGN (30" x 30")
10. **R1-3P:** "ALL WAY" SIGN (12" x 6")
11. **RMP-C:** CONSTRUCT CASE C PEDESTRIAN RAMP (SEE DETAIL ON SHEET 2)
12. **RR:** RAILROAD CROSSING MARKING
13. **RSW:** REMOVE (E) SIDEWALK, CURB AND GUTTER
14. **STP:** "STOP" MARKING

LEGENDS:

-  DEMO AREA
-  A.C. CONFORM (SEE CITY STD DWG NO. G1)

NOTE:

REMOVE EXISTING STRIPES/LEGENDS THAT CONFLICTS WITH THE PROPOSED IMPROVEMENTS.

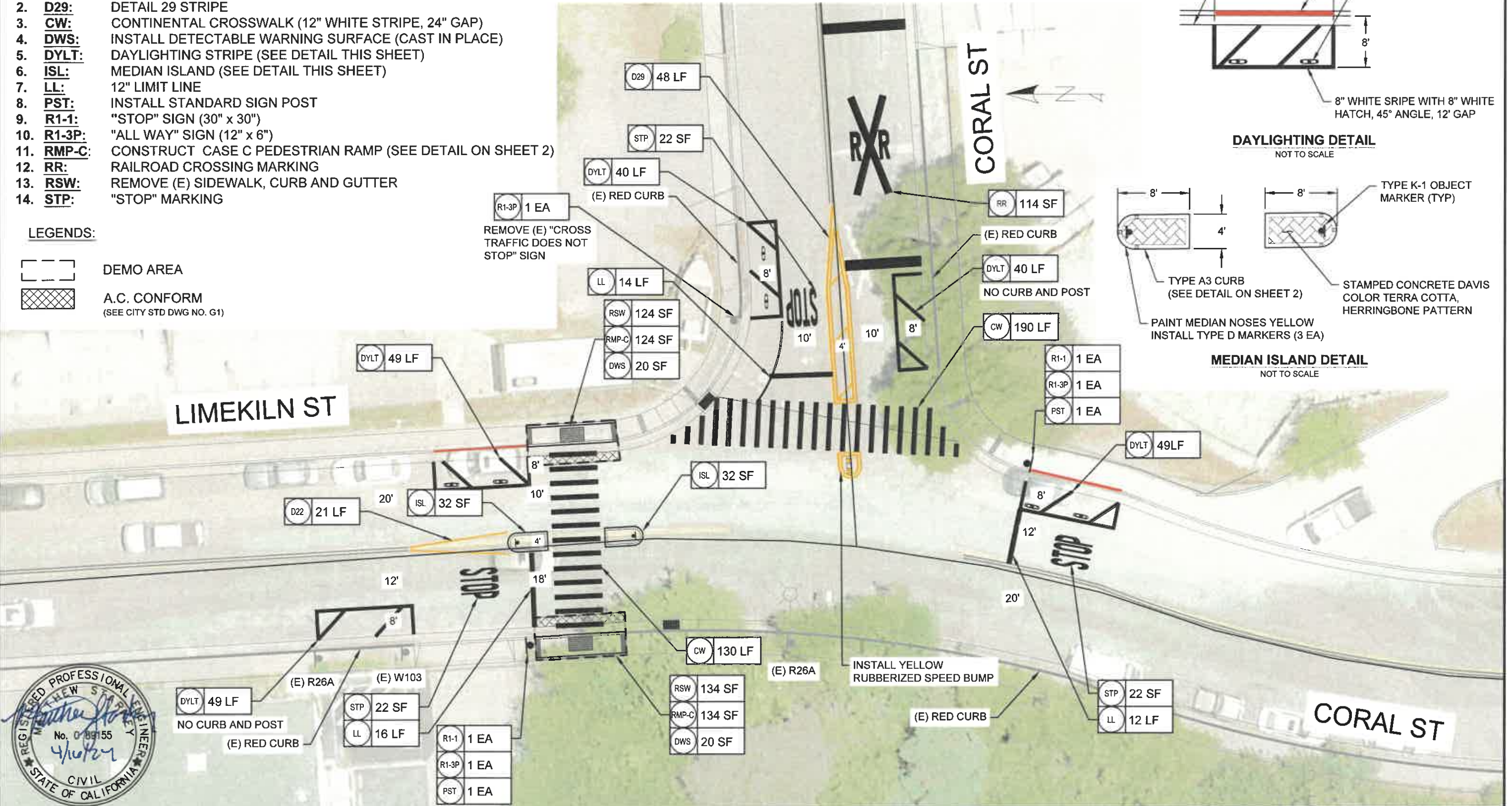
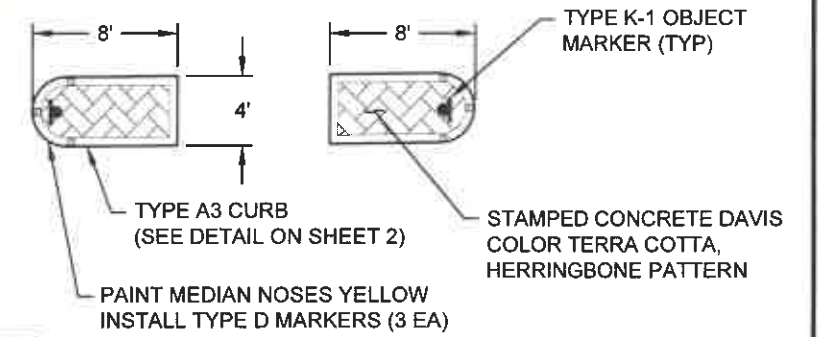
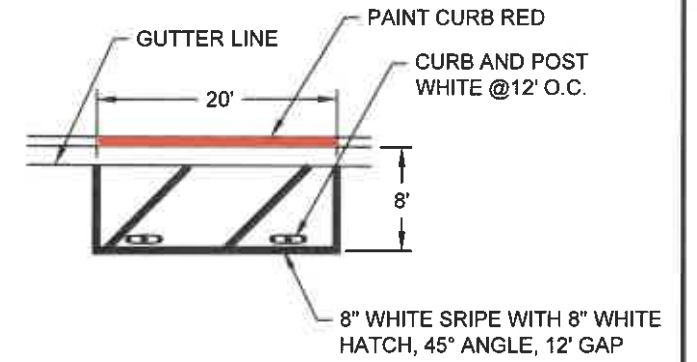

REVISIONS



CITY OF SANTA CRUZ
PUBLIC WORKS DEPARTMENT
809 Center Street, Room 201
Santa Cruz, CA 95060

CORAL ST - LIMEKILN ST IMPROVEMENTS PLAN

REFERENCES FIELD BOOK: # DRAWING #: #	DATE	04/16/224	SCALE	1" = 20'
	DRAWN	DnC	SHEET	2 OF 3
	DESIGN	DnC	VAULT NO.	
	CHECKED	MS/DE/RV	#7160	

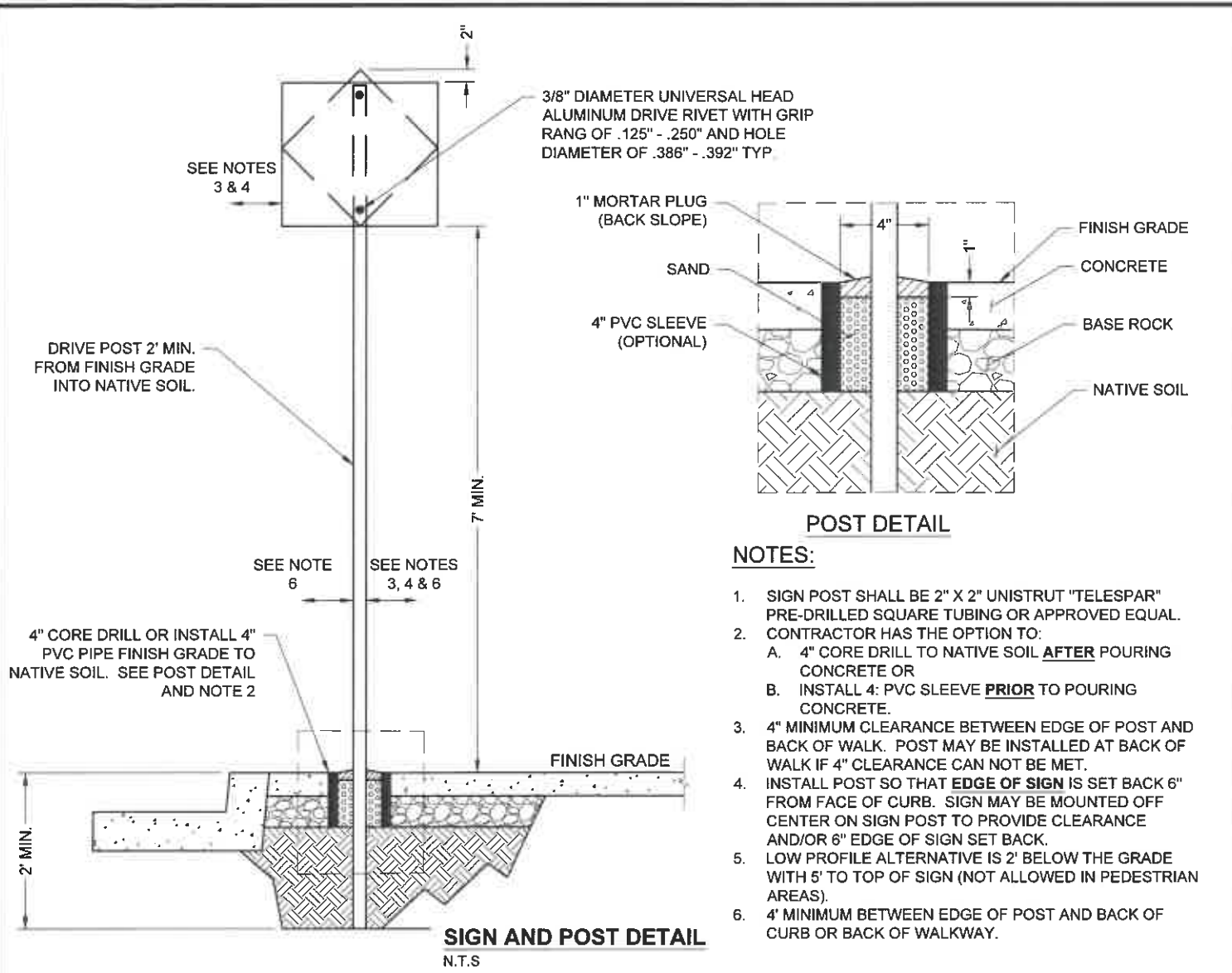

- NOTES:**
- SIGN POST SHALL BE 2" X 2" UNISTRUT "TELESPAR" PRE-DRILLED SQUARE TUBING OR APPROVED EQUAL. CONTRACTOR HAS THE OPTION TO:
 - 4" CORE DRILL TO NATIVE SOIL **AFTER** POURING CONCRETE OR
 - INSTALL 4" PVC SLEEVE **PRIOR** TO POURING CONCRETE.
 - 4" MINIMUM CLEARANCE BETWEEN EDGE OF POST AND BACK OF WALK. POST MAY BE INSTALLED AT BACK OF WALK IF 4" CLEARANCE CAN NOT BE MET.
 - INSTALL POST SO THAT **EDGE OF SIGN** IS SET BACK 6" FROM FACE OF CURB. SIGN MAY BE MOUNTED OFF CENTER ON SIGN POST TO PROVIDE CLEARANCE AND/OR 6" EDGE OF SIGN SET BACK.
 - LOW PROFILE ALTERNATIVE IS 2' BELOW THE GRADE WITH 5' TO TOP OF SIGN (NOT ALLOWED IN PEDESTRIAN AREAS).
 - 4' MINIMUM BETWEEN EDGE OF POST AND BACK OF CURB OR BACK OF WALKWAY.

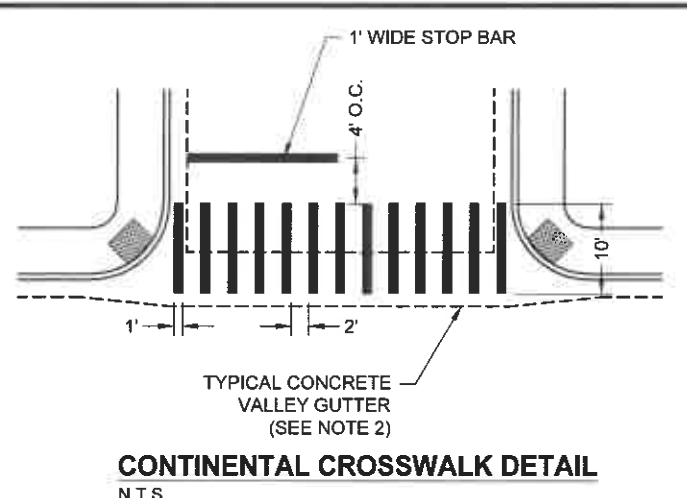

- NOTES:**
- ALL CROSSWALK MARKINGS MUST MEET CALTRANS THERMOPLASTIC SPECIFICATIONS, INCLUDING GLASS BEAD RETROREFLECTIVITY AND THICKNESS. PAINT SHALL ONLY BE USED IF APPROVED BY THE CITY ENGINEER.
 - PRIOR TO INSTALLING THERMOPLASTIC ON TO ANY CONCRETE, CLEAN AND APPLY PRIMER.
 - TYPICAL CROSSWALK STRIPE SHALL BE 1 FOOT WIDE WITH 2 FOOT GAP. 2 FOOT WIDE STRIPE SHALL BE INSTALLED AS DIRECTED BY THE CITY ENGINEER OR IF SHOWN ON PLANS.
 - BEGIN STRIPE WITHIN 3 FEET OF FACE OF CURB RAMP. INSTALL PERPENDICULAR TO PATH OF TRAVEL OR AS DIRECTED BY THE CITY ENGINEER.
 - TYPICAL CROSSWALK WIDTH IS 10 FEET BUT MAY VARY WIDER OR NARROWER BY LOCATION AND ON PLANS. NO CROSSWALK SHALL BE LESS THAN 8 FEET WIDE.
 - ALL CROSSWALK MARKING MUST BE WHITE EXCEPT THOSE NEAR SCHOOLS. PER CA MUTCD - A MARKED PEDESTRIAN CROSSWALK MAY BE YELLOW IF THE NEAREST POINT OF THE CROSSWALK IS NOT MORE THAN 600 FEET FROM A SCHOOL. INSTALL YELLOW AS DIRECTED BY THE CITY ENGINEER.

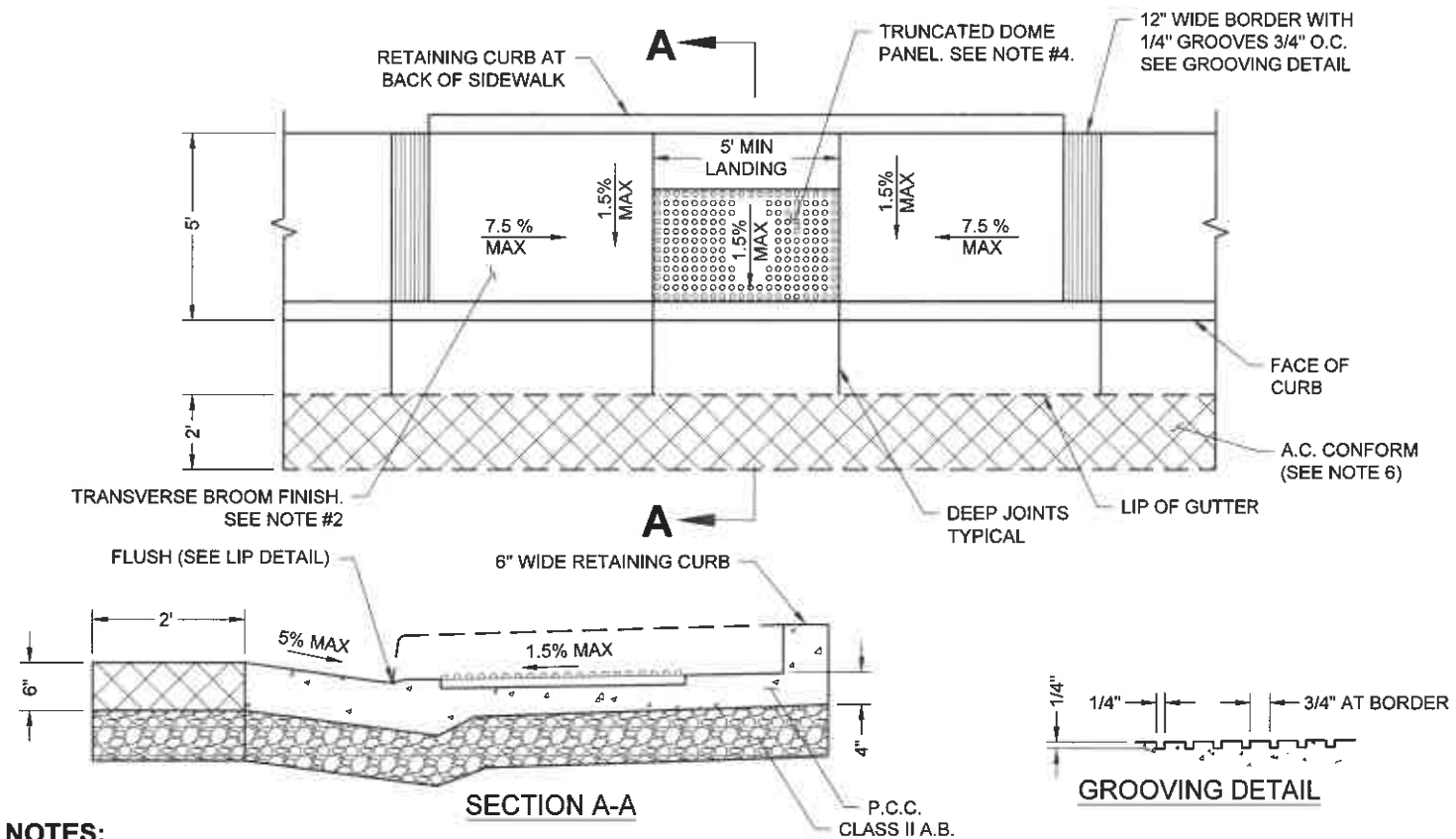

- NOTES:**
- THE CURB AND GUTTER ADJACENT TO THE RAMP SHALL BE MODIFIED SO THAT THE CROSS SLOPE OF THE GUTTER DOES NOT EXCEED FIVE PERCENT.
 - THE RAMP SURFACE SHALL HAVE ROUGH TRANSVERSE BROOMED FINISH.
 - NATIVE SUB-BASE SHALL BE COMPACTED. IF MATERIAL IS SILT OR CLAY IT SHALL BE "FIRM" ACCORDING TO ASTM OTHERWISE EXCAVATE TO 12" BELOW FINISH GRADE AND REPLACE WITH CLASS II AGGREGATE BASE AND COMPACT TO 95% RELATIVE AT OPTIMUM MOISTURE CONTENT.
 - CURB RAMPS SHALL HAVE WET SET 3' X 5' DETECTABLE WARNING SURFACE. THE EDGE OF THE DETECTABLE WARNING SURFACE NEAREST THE STREET SHALL BE BETWEEN 6" AND 8" FROM THE GUTTER FLOW LINE.
 - DOWEL INTO EXISTING CONCRETE WITH 18" #4 REBAR AT EVERY 24".
 - WIDTH OF A.C. CONFORM SHALL BE A MINIMUM OF 2 FEET AND SHALL BE 6" THICK ON TOP PF 6" THICK OF CLASS II A.B.

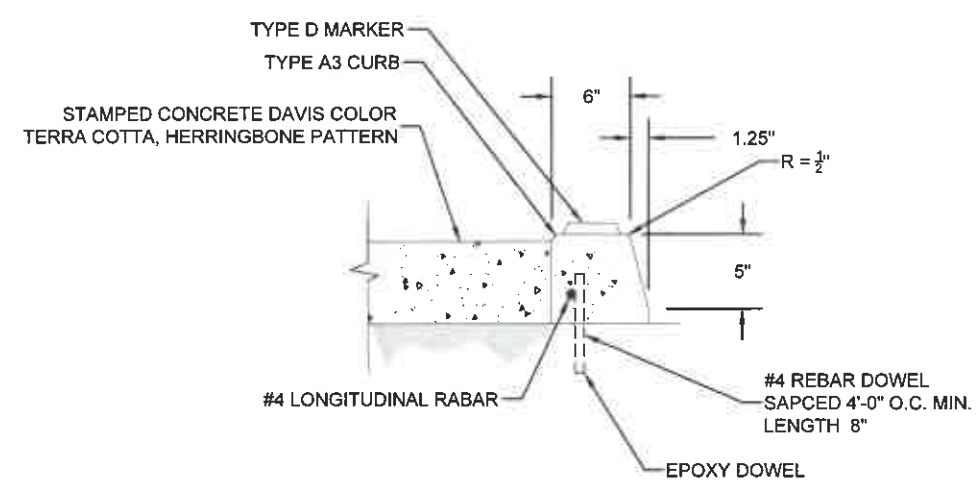
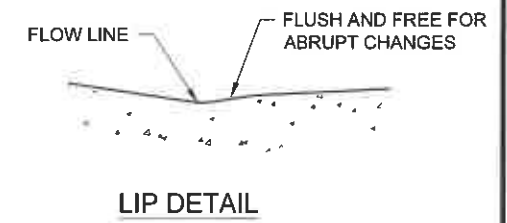

REVISIONS



CITY OF
SANTA CRUZ
PUBLIC WORKS DEPARTMENT
809 Center Street, Room 201
Santa Cruz, CA 95060

**CORAL ST - LIMEKILN ST
DETAIL SHEET**

REFERENCES	DATE	04/16/2024	SCALE	NOT TO SCALE
FIELD BOOK:	DRAWN	DnC	SHEET	3 OF 3
#	DESIGN	DnC	VAULT NO.	
DRAWING #:	CHECKED	MS/DE/RV	#7160	
#				